

Your mission is our commitment.



 **Hydrasearch**
RECREATIONAL

 **BUCK
ALGONQUIN**

Visit us online at www.hydrasearch.com to view our full product line.

Phone: 410.643.7145 ▪ Email: recreational@hydrasearch.com ▪ www.hydrasearch.com

Hose Application Chart	756																				
Hose & Hose Clamps	<table> <tr> <td>Heater, Bilge & Blower</td> <td>757</td> </tr> <tr> <td>Water & Sanitation</td> <td>758</td> </tr> <tr> <td>Exhaust & Fuel</td> <td>759 - 761</td> </tr> <tr> <td>Hose Clamps</td> <td>762 - 763</td> </tr> </table>	Heater, Bilge & Blower	757	Water & Sanitation	758	Exhaust & Fuel	759 - 761	Hose Clamps	762 - 763												
Heater, Bilge & Blower	757																				
Water & Sanitation	758																				
Exhaust & Fuel	759 - 761																				
Hose Clamps	762 - 763																				
Thru Hulls & Strainers	<table> <tr> <td>Scuppers</td> <td>764</td> </tr> <tr> <td>Thru-Hulls</td> <td>764 - 768</td> </tr> <tr> <td>Drains, Plugs & Strainers</td> <td>768 - 769</td> </tr> <tr> <td>Raw Water Strainers</td> <td>769 - 772</td> </tr> <tr> <td>Drain Plugs & Drains</td> <td>773 - 775</td> </tr> </table>	Scuppers	764	Thru-Hulls	764 - 768	Drains, Plugs & Strainers	768 - 769	Raw Water Strainers	769 - 772	Drain Plugs & Drains	773 - 775										
Scuppers	764																				
Thru-Hulls	764 - 768																				
Drains, Plugs & Strainers	768 - 769																				
Raw Water Strainers	769 - 772																				
Drain Plugs & Drains	773 - 775																				
Hose Fittings	<table> <tr> <td>Bronze Hose Fittings</td> <td>775</td> </tr> <tr> <td>Sealand & Tuff-Lite Fittings</td> <td>776</td> </tr> <tr> <td>Marelon Fittings</td> <td>777</td> </tr> <tr> <td>Marine East Hose Fittings</td> <td>778 - 779</td> </tr> <tr> <td>SeaTech Quick Connect Fittings</td> <td>780 - 784</td> </tr> <tr> <td>Pipe Fittings</td> <td>784 - 787</td> </tr> <tr> <td>Copper Tubing & Strapping</td> <td>788</td> </tr> <tr> <td>Fairview Brass Fittings</td> <td>788 - 794</td> </tr> <tr> <td>Garden Hose Fittings</td> <td>794 - 795</td> </tr> <tr> <td>EVM Aluminum Fittings</td> <td>795</td> </tr> </table>	Bronze Hose Fittings	775	Sealand & Tuff-Lite Fittings	776	Marelon Fittings	777	Marine East Hose Fittings	778 - 779	SeaTech Quick Connect Fittings	780 - 784	Pipe Fittings	784 - 787	Copper Tubing & Strapping	788	Fairview Brass Fittings	788 - 794	Garden Hose Fittings	794 - 795	EVM Aluminum Fittings	795
Bronze Hose Fittings	775																				
Sealand & Tuff-Lite Fittings	776																				
Marelon Fittings	777																				
Marine East Hose Fittings	778 - 779																				
SeaTech Quick Connect Fittings	780 - 784																				
Pipe Fittings	784 - 787																				
Copper Tubing & Strapping	788																				
Fairview Brass Fittings	788 - 794																				
Garden Hose Fittings	794 - 795																				
EVM Aluminum Fittings	795																				
Valves	<table> <tr> <td>Valves</td> <td>796 - 800</td> </tr> <tr> <td>Water Inlets & Outlets</td> <td>800 - 801</td> </tr> <tr> <td>Faucets</td> <td>801</td> </tr> <tr> <td>Vented Loops</td> <td>801</td> </tr> </table>	Valves	796 - 800	Water Inlets & Outlets	800 - 801	Faucets	801	Vented Loops	801												
Valves	796 - 800																				
Water Inlets & Outlets	800 - 801																				
Faucets	801																				
Vented Loops	801																				



- EX — Designed to give excellent service
 G — Designed to give good service in normal applications
 C — Product can give good service with proper installation, may not be suitable in all applications.
 X — Not recommended
 NA — Not available in size range
 1 — Can easily be bent into tight radius
 2 — Can be bent into gradual radius
 3 — May kink in applications requiring bend radius

Series	Type	Size	Application							
Fresh Water Systems			Non-pressurized supply	Hot	Cold	Water tank fill	Drain line below water line	Drain line to sump or above water line	Water tank vent	Flexibility
164	All Clear Reinforced PVC - Blue Tracer	1/2" to 3/4"	EX	G	EX	N/A	G	G	G	3
162	All Clear Reinforced PVC - Red Tracer	3/8" to 1-1/2"	EX	EX	EX	G	G	G	G	2
150	PVC Tubing - Clear	3/16" to 1-1/2"	G	X	X	C	X	G	G	3
148	Vac Extra Heavy Duty	5/8" to 1-1/2"	N/A	X	X	EX	EX	EX	EX	2
149	Live Well Hose	5/8" to 1-1/2"	X	X	X	X	EX	EX	C	2
141	Multiflex	5/8" to 3"	C	X	X	EX	X	EX	N/A	1

Series	Type	Size	Application					
Sanitation Systems			Toilet to Holding Tank	Holding Tank Pump Out	Holding Tank to	Toilet Water Inlet	Holding Tank Vent	Flexibility
250	Shieldsflex II	1/2" to 2-3/8"	EX	EX	Overboard Discharge	EX	EX	1
101	Sanitation Hose	1" to 1-1/2"	EX	EX	EX	N/A	N/A	1
105	Sanitation Hose	1-1/2"	EX	EX	EX	N/A	N/A	1
148	Vac Extra Heavy Duty	5/8" to 1-1/2"	G/EX	EX	EX	EX	EX	2
146	Vac Extra Heavy Duty/Commercial Grade	3/4" to 3"	G	EX	G	EX	EX	2
162	All Clear Reinforced PVC - Red Tracer	3/8" to 1-1/2"	X	X	X	EX	X	2
149	Live Well	5/8" to 1-1/2"	G	G	G	EX	EX	2

Series	Type	Size	Application					
Engine Hose			Engine Intake	Generator Intake	Engine Coolant	Engine Coolant (hose severe bend)	Exhaust Water Injection	Flexibility
250	Shieldsflex II	1/2" to 8"	EX	EX	EX	EX	EX	1
200	Marine Exhaust	1/2" to 14"	X	C	EX	X	G	3
135	#1350 HD= Water Hose	1/2" to 1"	X	C	G	X	G	3
160	#1600 Water Hose	1/4" to 1-1/4"	X	G	EX	X	G	2
202	Nautiflex Silicone Exhaust Hose - Blue Series	1" to 14"	X	X	EX	X	C	
252	Shieldsaust-C	1-1/2" to 8"	EX	EX	EX	EX	EX	1
262	Corrugated Nautiflex Silicone Exhaust Hose	3/4" to 10"	EX	EX	EX	EX	EX	1

Series	Type	Size	Application						
Fuel Systems			Oil Tank Fill	Fuel Tank Fill	Fuel Feed Inboard/Outdrive	Fuel Feed Outboard	Fuel Tank Vent Inboard	Fuel Tank Vent Outboard	Flexibility
315	Silverado 2000	1/4" to 5/8"	N/A	N/A	X	EX	C	EX	2
350	FIRE-ACOL	1 5/8" to 2-3/8"	EX	EX	N/A	N/A	N/A	EX	1
351	FIRE-ACOL-C	1-1/2"	EX	EX	N/A	N/A	N/A	N/A	1
355	Fuel Fill	1-1/4" to 1 1/2"	EX	EX	N/A	N/A	N/A	N/A	1
368	Low Permeation Fuel Hose	1/4" to 5/8"	N/A	N/A	EX	EX	N/A	N/A	1
369	FIRE-ACOL Fuel Vent Hose	5/8"	N/A	N/A	X	X	EX	EX	1

Shields**135 Extra Heavy Duty Heater Hose**

- For critical water connections
- Excellent bend radius
- Resists heat, cold, ozone, mild chemicals and sea water
- Operating temperature range -40F to +190F
- Burst pressure: 200 PSI (except 1", 150 PSI)
- Packaged 50 feet per box or sold by the foot

Part # 50' box	ID	OD	Part # Foot
SHI 135-0126B	1/2"	13/16"	SHI 135-1/2"B
SHI 135-0586B	5/8"	31/32"	SHI 135-5/8"B
SHI 135-0346B	3/4"	11/64"	SHI 135-3/4"B
SHI 135-1006B	1"	13/64"	SHI 135-1"B

Shields**160 Heater Hose**

- For critical water connections
- Heat exchanger, toilet intake, small engine intake, bilge pump intake/discharge
- Below water line drains and scuppers
- EPDM tube and cover, fabric reinforced, good bend radius.
- Resistant to: mild chemicals, heat, cold, ozone, salt water.
- Temperature range: -40° to +190° F
- Sold by the foot

SHI 160-1-1/4"	1.75" OD, per foot
SHI 160-1-1/2"	2.2" OD, per foot

Rule Bilge Hose

- Corrugated for flexibility
- Resistant to detergents, oil, gasoline, diesel and salt water
- Packaged 50 feet per box or sold by the foot

RUL 90 2" I.D for Rule 4000 GPH pumps

Shields 120 Bilge Hose

- Single layer corrugated black polyethylene
- Resistant to: mild chemicals, salt water
- Clamping cuff every foot
- Packaged 50 feet per box or sold by the foot

Part # 50' Box	ID	Bend Radius	Part # Foot
SHI 120-0346	3/4"	3/4"	SHI 120-3/4"
SHI 120-1186	1-1/8"	1"	SHI 120-1-1/8"
SHI 120-1146	1-1/4"	1-1/2"	SHI 120-1-1/4"
SHI 120-1126	1-1/2"	2"	SHI 120-1-1/2"

Shields 140 Bilge Hose

- PVC supported by vinyl covered steel wire
- Nylon reinforced
- Resistant to: mild chemicals, salt water
- Uses left hand threaded cuffs
- Packaged 50 feet per box or sold by the foot.

Part # 50' Box	ID	OD	VAC	Part # Foot
SHI 140-1126	1-1/2"	1-3/4"	28	SHI 140-1-1/2"

Shields**420 Heavy Duty Black Vinyl Blower Hose**

- For venting bilge gases & fumes
- Resistant to ozone, sunlight and weather checking
- Wire vinyl coated carcass is corrosion resistant
- Vinyl construction won't support fire
- Sold by the foot

SHI 420-3"	Per foot
SHI 420-4"	Per foot

► Also See

Heater Craft Hose pg 473

Shields**141 PVC Flex Hose**

- Ideal for bilge pumps, livewell systems, shower or sink drains, and potable water fills
- Clear FDA formula PVC with black vinyl helix
- Flexible, abrasion resistant
- Resistant to: mild chemicals, salt water
- Uses right hand threaded cuffs
- Packaged 50 feet per box or sold by the foot

Part # 50' Box	ID	Part # Foot
SHI 141-0346	3/4"	SHI 141-3/4"
SHI 141-1006	1"	SHI 141-1"
SHI 141-1186	1-1/8"	SHI 141-1-1/8"
SHI 141-1146	1-1/4"	SHI 141-1-1/4"
SHI 141-1126	1-1/2"	SHI 141-1-1/2"

* Not for use with glycol based antifreeze

Shields 149 Livewell Hose

- Suitable for heavy duty bilge pumps, livewell circulation, and sink or baitwell drains
- Black smooth cover with vinyl helix
- Rated for full vacuum
- Resistant to mild chemicals and salt water
- Sold by the foot

SHI 149-1-1/8"	Per foot
----------------	----------

Shields 146 Clear Hose

Suitable for heavy duty bilge pumps, livewell circulation, potable water fills and sink or baitwell drains.

- Smooth cover clear FDA PVC with white vinyl helix
- Rated for full vacuum
- Resistant to: mild chemicals, salt water
- Packaged 50 feet per box or sold by the foot

Part # 50' Box	ID	OD	Part # Foot
SHI 146-0346	3/4"	31/32"	SHI 146-3/4"
SHI 146-1186	1-1/8"	1-7/16"	SHI 146-1-1/8"
SHI 146-1126	1-1/2"	1-3/4"	SHI 146-1-1/2"

Sealand**Odour-Safe *Plus* Sani-Hose**

- The best Sani-hose on the market
- Packaged 50 feet per box
- Sold by the foot

SLD 342871FT 1-1/2"



Top rated by Practical Sailor

Sealand**MaxFlex Sanitation Hose**

- High flexibility maintains full inside diameter even around tight corners
- Clamps easier than other hoses for airtight connections
- Packaged 50 feet per box
- Sold by the foot

SLD 341116FT 1-1/2"

**Shields 101 Saniflex Hose**

An expertly formulated compound makes an excellent choice for toilet application.

- EPDM tube & cover, wire reinforced, two fabric plies
- Kink resistant and flexible
- Resistant to toilet chemicals, odour permeation, ozone, salt water and heat
- Sold by the foot



Part #	ID	OD
SHI 101-1-1/2"	1-1/2"	1-55/64"

Shields 105 Poly X Sanitation Hose

Poly X Sanitation hose has a lifetime warranty against odour permeation. This ultimate sanitation hose combines the flexibility of a rubber hose with the permeation resistance of polyurethane.

- Polyurethane cover is heat, ozone, aging and abrasion resistant
- Tube is made of smooth, NBR and is chemical/detergent resistant
- Sold by the foot



Part #	ID	OD
SHI 105-1-1/2"	1-1/2"	1-27/32"

Shields 148 Sanitation Hose

Perfect for head intake, discharge and pump-out.

- Recommended for below water line
- Smooth white FDA grade PVC with vinyl helix
- Rated for full vacuum
- Resistant to: mild chemicals, salt water, permeation
- Packaged 50 feet per box or sold by the foot

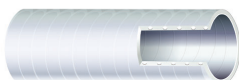

Part # 50' Box	ID	OD	Bend Radius	Part # Foot
SHI 148-0586	5/8"	3/4"	3"	SHI 148-5/8"
SHI 148-0346	3/4"	1"	3"	SHI 148-3/4"
SHI 148-1006	1"	1-1/4"	3"	SHI 148-1"
SHI 148-1146	1-1/4"	1-1/2"	4"	SHI 148-1-1/4"
SHI 148-1126	1-1/2"	1-3/4"	5"	SHI 148-1-1/2"

Shields 142 Sanitation Hose Cuffs

- Deep left hand thread design for hold fast installations
- Made of FDA approved material
- Sold individually

SHI 142-1120 1-1/2" ID

**Shields 150 Clear PVC Hose**

- FDA approved
- Single extrusion vinyl is non-toxic, odourless and tasteless
- It is best suited for potable water, sink drains, ice boxes and refrigerators
- Not recommended for hot water
- Packaged 50 feet per box or sold by the foot



Part # Box	ID	Wall	Part # Foot
SHI 150-0146	1/4"	.078"	SHI 150-1/4"
SHI 150-0386	3/8"	.094"	SHI 150-3/8"
SHI 150-0126	1/2"	.110"	SHI 150-1/2"
SHI 150-0586	5/8"	.110"	SHI 150-5/8"
SHI 150-0346	3/4"	.110"	SHI 150-3/4"
SHI 150-1006	1"	.125"	SHI 150-1"

Shields**162 Clear PVC Hose with Red Tracer**

Ideal for hot or cold water pressure systems, vent or drain lines and washdown pumps.

- Heavy wall FDA formula vinyl
- Polyester braid reinforcement – 250 psi burst pressure
- Packaged 50 feet per box or sold by the foot

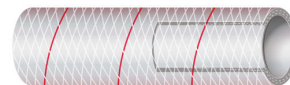

Part # 50' Box	ID	OD	Part # Foot
SHI 162-0386	3/8"	9/16"	SHI 162-3/8"
SHI 162-0126	1/2"	23/32"	SHI 162-1/2"
SHI 162-0586	5/8"	27/32"	SHI 162-5/8"
SHI 162-0346	3/4"	31/32"	SHI 162-3/4"
SHI 162-1006	1"	1-5/16"	SHI 162-1"
SHI 162-1146	1-1/4"	1-5/8"	SHI 162-1-1/4"
SHI 162-1126	1-1/2"	1-15/16"	SHI 162-1-1/2"

Shields**164 PVC Hose with Blue Tracer**

Designed specifically to handle tough applications like drain lines, and air conditioner circulation.

- White FDA formula vinyl tube
- Clear vinyl cover
- Polyester braid reinforcement - 250 psi burst pressure
- Packaged 50 feet per box or sold by the foot

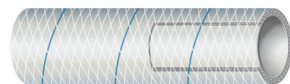

Part # 50' Box	ID	OD	Part # Foot
SHI 164-0126	1/2"	11/16"	SHI 164-1/2"
SHI 164-0586	5/8"	13/16"	SHI 164-5/8"
SHI 164-0346	3/4"	15/16"	SHI 164-3/4"

Shields Silicone Exhaust Hose

Wet Exhaust Hose SAE J2006 Type R1

- Primarily used for straight connections in the wet exhaust system and engine water circulation
- Blue silicone tube and cover with a smooth finish
- Flexible, easy to install and has four plies of synthetic fabric
- Temperature ranges from -20 degrees F to 350 degrees F
- Meets SAE J2006 Type R1 and ISO 13363:2004 - Type 2 - Class B standards
- Sold by the foot: 3' lengths

Part # Foot	I.D.	O.D.
SHI 202-2-1/2"	2-1/2"	2.862"
SHI 202-3"	3"	3.362"
SHI 202-3-1/2"	3-1/2"	3.862"
SHI 202-4"	4"	4.362"
SHI 202-5"	5"	5.362"
SHI 202-6"	6"	6.361"
SHI 202-8"	8"	8.362"



Shields Silicone Exhaust Hose

- Primarily used for main engine exhaust, generator exhaust, engine coolant circulation, engine intake and generator intake
- Blue silicone tube and cover with a smooth finish for easy cleaning
- Wire reinforced and will not collapse under suction or in a bend
- Corrugated cover allows the hose to bend for easy installation
- The Nautiflex, two ply construction, has wire captured between fabric plies.
- Resistant to exhaust fumes, ozone, mild chemicals, anti-freeze and saltwater
- Remains stable at elevated temperatures
- Temperatures ranges from -20 degrees F to 350 degrees F
- Meets SAE J2006 Type R2 and ISO 13362:2004 - Type 1 - Class B standards
- Sold by the foot: 12-1/2' lengths

Part # Foot	I.D.	O.D.
SHI 262-3/4"	3/4"	1-1/16"
SHI 262-1"	1"	1-5/16"
SHI 262-1-1/4"	1-1/4"	1-19/32"
SHI 262-1-1/2"	1-1/2"	1-53/64"
SHI 262-2"	2"	2-13/32"
SHI 262-2-1/2"	2-1/2"	2-7/8"
SHI 262-3"	3"	3-7/16"
SHI 262-3-1/2"	3-1/2"	4"
SHI 262-4"	4"	4-5/8"

Shields Silicone Couplers



- Blue silicone cover with a smooth finish for easy clean up and are fabric reinforced
- Remain stable at elevated temperatures and provide angular and longitudinal vibration absorption in wet exhaust systems
- Shields couplers correct slight offsets in pipes
- Resistant to exhaust fumes, ozone, mild chemicals, antifreeze and saltwater
- Single or double hump
- Temperature range is -20 degrees F to 350 degrees F
- Meets SAE J2006 Type R1 standards

SHI 272-4000	Single hump, 4" x 6"
SHI 272-5000	Single hump, 5" x 6"
SHI 272-6000	Single hump, 6" x 8"
SHI 272-8000	Single hump, 8" x 8"
SHI 274-6000	Double hump, 6"
SHI 274-8000	Double hump, 8"

Shields Silicone Elbows

- Blue silicone cover with a smooth finish for easy clean up and are fabric reinforced
- Remain stable at elevated temperatures and provide angular and longitudinal vibration absorption in wet exhaust systems
- Resistant to exhaust fumes, ozone, mild chemicals, antifreeze and saltwater
- Temperature range is -20 degrees F to 350 degrees F
- Meets SAE J2006 Type R1 standards

SHI 245S-3000	3", 45°
SHI 245S-4000	4", 45°
SHI 245S-5000	5", 45°
SHI 245S-6000	6", 45°



SHI 290S-2000	2", 90°
SHI 290S-3000	3", 90°
SHI 290S-4000	4", 90°
SHI 290S-5000	5", 90°
SHI 290S-6000	6", 90°
SHI 290S-8000	8", 90°



Shields

200 Softwall Exhaust Hose



- Black heavy walled synthetic rubber
- Reinforced with 2 or 4 plies of synthetic cord
- Resistant to: engine heat, exhaust fumes, ozone, mild chemicals, antifreeze, salt water
- Temperature range:
 - 20°F to +200°F continuous
 - +250°F intermittent
- Meets SAE J2006 Type R1
- Sold by the foot

Part # Foot	I.D.	O.D.
SHI 200-1-1/2"	1-1/2"	1-53/64"
SHI 200-1-5/8"	1-5/8"	2"
SHI 200-1-7/8"	1-7/8"	2-23/64"
SHI 200-2"	2"	2-31/64"
SHI 200-2-1/4"	2-1/4"	2-3/4"
SHI 200-2-3/8"	2-3/8"	2-7/8"
SHI 200-2-1/2"	2-1/2"	3"
SHI 200-3"	3"	3-9/16"
SHI 200-3-1/2"	3-1/2"	4-3/32"
SHI 200-4"	4"	4-17/32"
SHI 200-5"	5"	5-5/8"
SHI 200-6"	6"	6-11/16"
SHI 200-8"	8"	8-25/32"

Shields

250 Hardwall Exhaust Hose



Designed for wet exhaust service. This hose has the same features as 200 softwall plus a helix wire embedded in the core that provides additional strength for longer runs. Reinforcing also provides rigidity for tight radius and resists collapsing.

- Temperature range:
 - 20°F to +200°F continuous
 - +250°F intermittent
- Abrasion resistant
- Odour permeation resistant
- Meets SAE J2006 Type R2
- Sold by the foot

Part # Foot	Coil Size	I.D.	O.D.
SHI 250-1-1/2"	50'	1-1/2"	1-53/64"
SHI 250-1-5/8"	50'	1-5/8"	2"
SHI 250-1-7/8"	50'	1-7/8"	2-19/64"
SHI 250-2"	50'	2"	2-11/32"
SHI 250-2-3/8"	50'	2-3/8"	2-3/4"
SHI 250-2-1/2"	50'	2-1/2"	2-7/8"
SHI 250-3"	10'	3"	3-7/16"
SHI 250-3-1/2"	10'	3-1/2"	4"
SHI 250-4"	10'	4"	4-5/8"
SHI 250-4-1/2"	10'	4-1/2"	5-3/32"
SHI 250-5"	10"	5"	5-5/8"
SHI 250-6"	10'	6"	6-21/32"

Shields

252 Corrugated Hardwall Exhaust Hose



- Black synthetic rubber tube and cover
- Reinforced with double wire helix imbedded between plies of synthetic cord
- Resistant to: exhaust fumes, ozone, mild chemicals, antifreeze, salt water & abrasion
- Temperature range: -20°F to +200°F continuous
- +250°F intermittent
- Meets SAE J2006 Type R2

Part # Foot	I.D.	O.D.
SHI 252-1-1/2"	1-1/2"	2-7/8"
SHI 252-1-7/8"	1-7/8"	2-19/64"
SHI 252-2"	2"	2-13/32"
SHI 252-2-1/2"	2-1/2"	2-7/8"
SHI 252-3"	3"	3-7/16"
SHI 252-4"	4"	4-5/8"

Wonderflex Butyl Hose

- Constructed with a continuous, tempered, high-carbon, helical wound, steel wire embedded in a smooth bore butyl core and wrapped and bonded permanently to a durable, nylon fabric, rubber impregnated cover
- Strength and flexibility for kink free bends and turbulence free material transmission
- UL listed and meets USCG requirements for wet exhaust systems
- Temperature range - 40° F to 240° F
- Standard 10 foot lengths
- Not to be used for fuel filler hose

WON 5/8"X10'
 WON 3/4"X10'
 WON 7/8"X10'
 WON 1"X10'
 WON 1-1/8"X10'
 WON 1-1/4"X10'
 WON 1-3/8"X10'
 WON 1-1/2"X10'
 WON 1-5/8"X10'
 WON 1-3/4"X10'
 WON 1-7/8"X10'
 WON 2"X10'
 WON 2-1/4"X10'
 WON 2-1/2"X10'



Shields**368 Type A1 Fuel Hose**

Fuel Feed - Gasoline up to 85% ethanol blended fuels/ diesel/ bio-diesel all blends

- Complies with EPA and CARB permeation requirements
- Meets USCG Type A1-15 requirements for pleasure boats
- Plastic barrier veneer with NBR outer layer tube
- Polyester reinforced
- Weather/UV resistant NBR/PVC cover
- Meets SAE J1527 Type A1-15 ISO 7840 Type A1 NMMA/CE type accepted
- Temperature range: -20°F to 212°F
- Packaged 50 feet per box or sold by the foot

Part # 50' Box	ID	OD	Part # Foot
SHI 368-0146	1/4"	19/32"	SHI 368-1/4"
SHI 368-0566	5/16"	11/16"	SHI 368-5/16"
SHI 368-0386	3/8"	25/32"	SHI 368-3/8"
SHI 368-0126	1/2"	27/32"	SHI 368-1/2"

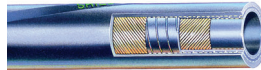
Shields**355 Type A2 Fuel Hose**

- Fire-retardant fuel hose meets or exceeds all requirements of ISO 7840 and SAE J5127 standards required by USCG, ABYC and NMMA
- Resistant to gasoline, diesel and alcohol-enhanced fuels
- Reinforced with helical wire between plies of nylon spiral cord
- Provides strength and flexibility
- Resistant to abrasion, heat and ozone
- Burst pressure is 90 PSI
- Sold by the foot

Part # Foot	ID	OD
SHI 355-1-1/2"	1-1/2"	1-57/64"

Shields**350 Type A2 Fuel Fill Hose**

- Resists gasoline/alcohol blends
- Compounded for low permeation
- Reinforced with wire helix imbedded between plies of HD synthetic cord
- Abrasion resistant
- Temperature range: -5°F to 180°F
- Burst pressure is 90 PSI
- Meets SAE J1527 Type A2 and ISO 7840 Type A2 NMMA/CE Type Accepted
- Sold by the foot

Part # Foot	ID	OD
SHI 350-2"	2"	2-31/64"

Shields**351 Fire-Acol "C" Fuel Hose**

- Extra flexible fuel fill for gas or diesel
- Compounded for low permeation
- Corrugated for extra flexibility
- Wire reinforced
- Burst pressure is 90 PSI
- For pleasure boats only
- Temperature range: -5°F to 180°F
- Meets SAE J1527 type A2 and ISO 7840 type A2 NMMA/CE Type Accepted standards
- Sold by the foot

Part # Foot	ID	OD
SHI 351-1-1/2"	1-1/2"	1-57/64"

Shields**369 Type A2 Vent Hose**

- Fire-acol fuel vent hose resists gasoline/alcohol blended fuel and is fire resistant
- Features a weather/UV resistant NBR/PVC cover
- Primarily used for fuel vent lines (gasoline up to 85% ethanol blended fuels/diesel fuels)
- Meets USCG Type A2 requirements for pleasure boats and meets SAE J1527 Type A2, ISO 7840 Type A2 and NMMA/CE Type accepted standards
- Temperature ranges from -20°F to 160°F
- Packaged 50 feet per box or sold by the foot

Part # 50' Box	ID	OD	Part # Foot
SHI 369-0586	5/8"	.96"	SHI 369-5/8"

Shields 315 Fuel Tank Vent Hose

- EPA compliant outboard fuel line
- For use in above deck primer bulb assemblies
- Resistant to Ethanol blend fuels
- CARB compliant for small engine use
- Packaged 50 feet per box or sold by the foot

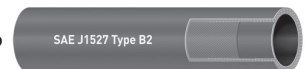

Part # 50' Box	ID	OD	Part # Foot
SHI 315-0586	5/8"	29/32"	SHI 315-5/8"

► Also See

Fuel Hose pg 685

ABA 12mm Hose Clamps

- 316 stainless steel
- Acid resistant
- No perforations in the band
- Rolled up band edges to minimize hose wear
- Vibration proof six degree thread pitch
- Hex head worm screw 7mm (9/32") across flats



Part #	Range MM	SAE Size	Dia. Inches	
			Min.	Max.
ABA 13624	15-24	8	5/8"	1"
ABA 13628	19-28	10	3/4"	1-1/8"
ABA 13632	22-32	12	7/8"	1-1/4"
ABA 13638	26-38	16	1-1/16"	1-1/2"
ABA 13644	32-44	20	1-1/4"	1-3/4"
ABA 13650	38-50	24	1-1/2"	2"
ABA 13657	32-57	28	1-1/4"	2-1/4"
ABA 13664	38-64	32	1-1/2"	2-1/2"
ABA 13670	44-70	36	1-3/4"	2-3/4"
ABA 13676	51-76	40	2"	3"
ABA 13683	57-83	44	2-1/4"	3-1/4"
ABA 13689	64-89	48	2-1/2"	3-1/2"
ABA 13694	70-95	52	2-3/4"	3-3/4"
ABA 13696	76-102	56	3"	4"
ABA 13697	83-108	60	3-1/4"	4-1/4"
ABA 13698	89-114	64	3-1/2"	4-1/2"
ABA 13699	89-127	72	3-1/2"	5"
ABA 66140	102-140	80	4"	5-1/2"
ABA 66152	114-152	88	4-1/2"	6"
ABA 66165	127-165	96	5"	6-1/2"
ABA 66178	140-178	104	5-1/2"	7"
ABA 66191	152-191	112	6"	7-1/2"
ABA 66203	165-203	120	6-1/2"	8"
ABA 66216	178-216	128	7"	8-1/2"
ABA 66232	194-232	138	7-5/8"	9-1/8"
ABA 66257	219-257	154	8-5/8"	10-1/8"
ABA 66283	244-283	170	9-5/8"	11-1/8"
ABA 66308	270-308	186	10-5/8"	12-1/8"

ABA Clamp Driver

- Flexible drivers for all clamp types
- 10" in length

ABA 60002

7 mm

**Sierra Oetiker Clamp Pincher**

- Forged steel
- Straight jaw

SIE 18-9141

**AWAB Torro 9mm Hose Clamps**

- Torro clamps are crafted entirely of AISI 304 stainless steel
- Torro clamps have rolled-up band edges and solid bands, reducing the possibility of hose damage; the solid band of the Torro clamps eliminates cracks starting at perforations, extending the service life of the clamps
- Can be used in environments with a moderately aggressive atmosphere and some risk of corrosion
- 9mm band width



Part #	SAE	Range
AWA NT09100-W4**	56	3-1/8" to 4"
AWA NT09120-W4**	68	4" to 4-3/4"
AWA NT09130-W4**	74	4-5/16" to 5-1/8"
AWA NT09140-W4**	80	4-3/4" to 5-1/2"
AWA NT09150-W4**	86	5-1/8" to 5-7/8"
AWA NT09160-W4**	93	4-1/2" to 6-5/16"
AWA NT09170-W4**	99	5-7/8" to 6-11/16"
AWA NT09180-W4**	105	6-5/16" to 7-1/16"

** Limited Quantity

Sierra Oetiker Hose Clamps

- 304 stainless steel construction
- Narrow Band: concentrates transmission of clamping force
- 360° Stepless: Uniform compression and surface pressure
- Clamp Ear: Compensates for component tolerances, adjustable surface pressure
- Dimple: Increases clamping force
- Burr-free strip edges: Reduces risk of damage to clamped parts
- Sold 10/pkg



Part #	Ear Width mm	Band Width mm	Nominal ID	
			Inches	mm
SIE 18-9126-9	5.5	5	3/8"	9.5
SIE 18-9127-9	5.5	5	13/32"	10.5
SIE 18-9129-9	5.5	7	1/2"	13.3
SIE 18-9130-9	8	7	17/32"	13.8
SIE 18-9131-9	8	7	35/64"	14
SIE 18-9132-9	8	7	9/16"	14.5
SIE 18-9133-9	8	7	5/8"	15.7
SIE 18-9134-9	8	7	11/16"	17
SIE 18-9140-9	10	7	22/32"	18.5
SIE 18-9135-9	10	7	13/16"	21
SIE 18-9136-9	10	7	1"	25.6
SIE 18-9137-9	10	7	1-3/16"	30.1
SIE 18-9138-9	10	7	1-1/4"	31.6
SIE 18-9139-9	10	7	1-5/8"	41

Fairview Two Ear Clamp

- 304 Stainless steel

Part #	Tube
FRV HC9-9SS	.512" to .591"



Ideal Hose Clamps

- All stainless steel gear clamps
- The band and one piece housing are of 301 stainless steel and the screw is of 305 stainless steel
- The MAH micro clamps have a 5/16" band
- The HAS models have a full 1/2" band



Part #	Size Range			
	Min.		Max.	
	inches	mm	inches	mm
IDE MAH 4	7/32"	6	5/8"	16
IDE MAH 5	7/16"	8	11/16"	19
IDE MAH 6	5/16"	8	7/8"	22
IDE MAH 8	7/16"	11	1"	25
IDE MAH 10	1/2"	13	1-1/16"	27
IDE MAH 12	9/16"	14	1-1/4"	32
IDE HAS 6	3/8"	10	7/8"	22
IDE HAS 8	7/16"	11	1"	25
IDE HAS 10	9/16"	14	1-1/16"	27
IDE HAS 12	9/16"	14	1-1/4"	32
IDE HAS 16	11/16"	17	1-1/2"	38
IDE HAS 20	3/4"	19	1-3/4"	44
IDE HAS 24	1-1/16"	27	2"	51
IDE HAS 28	1-5/16"	33	2-1/4"	57
IDE HAS 32	1-9/16"	40	2-1/2"	63
IDE HAS 36	1-1/16"	46	2-3/4"	70
IDE HAS 40	2-1/16"	52	3"	76
IDE HAS 44	2-5/16"	59	3-1/4"	82
IDE HAS 48	2-9/16"	65	3-1/2"	89
IDE HAS 52	2-13/16"	71	3-3/4"	95
IDE HAS 56	3-1/16"	78	4"	101
IDE HAS 60	3-5/16"	84	4-1/4"	107
IDE HAS 64	3-9/16"	90	4-1/2"	114
IDE HAS 72	4-1/16"	103	5"	127
IDE HAS 84	4-15/16"	125	5-3/4"	146
IDE HAS 96	4-1/2"	114	6-1/2"	165
IDE HAS 104	5"	127	7"	178
IDE HAS 128	6-1/2"	165	8-1/2"	216

ABA 9mm Narrow Clamps

- 316 stainless steel

ABA 13614	5/16" - 9/16", each
ABA 13617	7/16" - 11/16", each
ABA 13620	1/2" - 13/16", each



ABA Mini Clamp

- 304 stainless steel

ABA 13514	#14, 17/32" - 19/32", each
-----------	----------------------------



T-Bolt Band Hose Clamps

- Made of 18-8 stainless steel

Part #	Size
BUC 70TBC150SS	1.28 - 1.59"
BUC 70TBC175SS	1.63 - 1.83"
BUC 70TBC188SS	1.76 - 1.96"
BUC 70TBC200SS	1.78 - 2.09"
BUC 70TBC225SS	2.03 - 2.34"
BUC 70TBC250SS	2.38 - 2.58"
BUC 70TBC275SS	2.53 - 2.84"
BUC 70TBC300SS	2.80 - 3.08"
BUC 70TBC325SS	3.03 - 3.34"
BUC 70TBC350SS	3.30 - 3.58"
BUC 70TBC375SS	3.55 - 3.83"
BUC 70TBC400SS	3.80 - 4.08"
BUC 70TBC425SS	4.05 - 4.33"
BUC 70TBC450SS	4.30 - 4.58"
BUC 70TBC475SS	4.55 - 4.83"
BUC 70TBC500SS	4.80 - 5.08"
BUC 70TBC550SS	5.30 - 5.58"
BUC 70TBC575SS	5.55 - 5.83"
BUC 70TBC600SS	5.80 - 6.08"
BUC 70TBC625SS	6.05 - 6.33"
BUC 70TBC650SS	6.30 - 6.58"
BUC 70TBC675SS	6.55 - 6.83"
BUC 70TBC700SS	6.80 - 7.08"
BUC 70TBC750SS	7.30 - 7.58"
BUC 70TBC800SS	7.80 - 8.08"
BUC 70TBC850SS	8.30 - 8.58"
BUC 70TBC875SS	8.30 - 8.87"
BUC 70TBC900SS	8.80 - 9.08"
BUC 70TBC950SS	9.30 - 9.58"
BUC 70TBC1000SS	9.80 - 10.08"
BUC 70TBC1088SS	10.43 - 11.00"
BUC 70TBC1200SS	11.80 - 12.08"
BUC 70TBC1288SS	12.43 - 13.00"
BUC 70TBC132LSS	12.75 - 13.32"
BUC 70TBC146LSS	14.20 - 14.77"



PYI Clamp Jackets

- 1/2", black rubber
- Provides a safe and finished look for hose clamps

PYI CJ1225	25
PYI CJ12100	100



Attwood Scupper Valve

- Cast from #316 stainless steel
- Visible areas are polished to a mirror finish, then through passivation for additional protection
- Thick steel sidewalls withstand continual stress and hose flexing
- Solid silicone gasket - will not deteriorate or shrink over time
- Excellent resistance to UV & weather-aging
- Watertight, fool-proof, one-piece seal
- Eliminates the need to form and apply sealant or caulk
- Caution: Thru-Hull connectors are designed for installation above the water line only
- 1-1/2" hose x Length: 5-1/2"

**ATT 66553-1**

Bulk

ATT 66553-3

Packaged

Attwood Thru-Transom Scupper

Designed for boats with self bailing cockpits this scupper is a combination of plastic and rubber washers with a flap designed to act as a valve for water to exit. Mounted on the transom above the waterline the rubber flapper prevents backwash from entering your cockpit.



- Hose ID: 1-1/2"
- Overall length: 6-1/4"
- Max hull thickness: 3-1/8"
- Flange diameter: 2-7/8"
- Cut out hole diameter: 2"

ATT 3881-1**Perko Short Scupper**

- Chrome plated cast bronze thru-hull scupper with a recessed flapper
- Use with 1-1/2" hose and hulls to 1-3/4"
- 3-1/8" flange

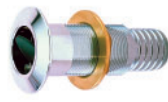
**PER 377-A08-CHR****Perko Cockpit Scupper**

- Molded white plastic
- Flush mount
- For use when discharge is above the water line
- Insert prevents passage of large objects without restricting water flow
- Hose size: 1-1/2"
- Maximum hull thickness: 1-3/4"
- Flange OD: 2-3/4"

**PER 285-DP****Perko****Adjustable Thru-Hull Scupper**

- Molded white plastic with soft black scupper valve
- For surface thickness from 2" to 4-3/4"
- Female portion of scupper can be cut down by one rib for each 1/4" difference between hull thickness and 4-3/4"
- OD flange: 2-15/16"

**PER 343**

Parts:

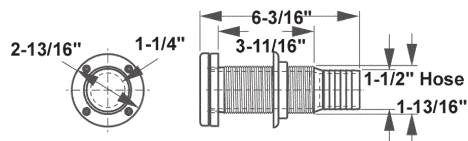
PER 333-DP0-99A Spare flapper**Sea-Dog Thru-Hull w/Scupper Valve**

- Injection molded acetal

SED 520510-1**Rabud Sea Scuppers**

- Transom drain
- For all self bailing applications
- Retrofits most rubber flappers
- Clear polycarbonate housing
- Solid polypropylene ball
- UV stabilized



Part #	Drain Tube	Dia	Height
RHS SS1-C	1"	2-3/4"	2"
RHS SS3-C	Up to 3"	4-1/2"	3-1/4"

T-H Marine Ball Scupper

- Replaces worn out flapper scuppers
- 70% more drainage than competitive models
- Twist off for easy cleaning
- Retrofits all hole patterns
- Stainless steel lock screw for safety
- Seal is slotted to fit over 1-1/4" motorwell tubes

**THM FMS-1-0-DP****Perko Thru-Hull Scupper**

- For surface mount applications
- Molded white plastic with soft black flapper valve
- Flange OD: 2-7/8"
- Use #6 fasteners

**PER 365-DP****Sea-Dog Scupper Valve**

- Injection molded nylon
- Use #6 FH fasteners
- OD: 2-3/4", I.D: 1-3/4"

**SED 520500-1****Buck Algonquin Thru-Hulls w/Hose Barb**

- Cast bronze, machined finish with molded hose barb
- Caulking groove cut behind head



Part #	Hose Size	Shank Length	Flange Diameter
BUC THH75	3/4"	3-1/4"	2-1/16"
BUC THH150	1-1/2"	3-7/8"	3-5/32"

Buck Algonquin Bronze Thru-Hulls

- Mushroom head, cast bronze, machine finish, completely machined thru-hull
- Caulking groove cut beneath head



Part #	NPS Size	Shank Length	Flange Dia.
BUC TH-38	3/8"	2-1/4"	1-9/16"
BUC TH-50	1/2"	2-1/8"	1-13/16"
BUC TH-75	3/4"	2-3/8"	2-1/16"
BUC TH-100	1"	2-3/4"	2-3/8"
BUC TH-125	1-1/4"	3-1/4"	3-1/16"
BUC TH-150	1-1/2"	3-1/2"	3-3/8"
BUC TH-200	2"	4"	3-5/8"
BUC TH-250	2-1/2"	4"	4-1/32"
BUC TH-300	3"	5-1/4"	4-11/16"
BUC TH-75-XL	3/4"	5-9/16"	2"
BUC TH-100-XL	1"	5-9/16"	2-1/2"
BUC TH-125-XL	1-1/4"	5-9/16"	3-1/16"
BUC TH-150-XL	1-1/2"	5-9/16"	3-3/8"
BUC TH-200-XL	2"	5-9/16"	3-5/8"

Buck Algonquin Bronze Thru-Hulls

- Cast bronze, machine finish, flush type for smooth skinned hull finish
- Flange thickness: 3/8", flange angle: 45°
- Available with or without screen



Part #	NPS Size	Shank Length	Flange Dia.	Screen
BUC TH-50-FS	1/2"	2-5/16"	2-1/2"	Y
BUC TH-75-FS	3/4"	2-5/16"	2-1/2"	Y
BUC TH-100-FS	1"	2-1/2"	3"	Y
BUC TH-125-FS	1-1/4"	3-1/8"	3"	Y
BUC TH-150-FS	1-1/2"	3-3/8"	3-1/4"	Y
BUC TH-75-F	3/4"	2-5/16"	2-1/2"	N
BUC TH-100-F	1"	2-1/2"	3"	N
BUC TH-125-F	1-1/4"	3-1/8"	3"	N
BUC TH-150-F	1-1/2"	3-3/8"	3-1/4"	N

Buck Algonquin Thru-Hull Nuts

Part#	Fits Thru-Hull
BUC THN-38	3/8"
BUC THN-50	1/2"
BUC THN-75	3/4"
BUC THN-100	1"
BUC THN-125	1-1/4"
BUC THN-150	1-1/2"
BUC THN-250	2-1/2"
BUC THN-300	3"



Gemlux Barbed Thru-Hulls

- 316 Cast stainless steel with GEMPLUX polish finish
- Neck is threaded to approximately 3/8" from flange
- Solid silicone gasket
- One man installation
- Includes grounding screw on nut
- Engineered and built to ABYC specifications



71000 Series



72000 Series

Part #	Hose	Shank Length	Max. Hull Thickness
GEM 71001	5/8"	3.06"	1-1/16"
GEM 71002	3/4"	3.62"	1-5/8"
GEM 71003	1"	3.73"	1-3/4"
GEM 72004-2	1-1/8"	2.75"	3/4"
GEM 71004	1-1/8"	3.73"	1-3/4"
GEM 71005	1-1/4"	3.84"	1-7/8"
GEM 71006	1-1/2"	3.84"	1-7/8"

Gemlux Threaded Thru-Hulls

- 316 cast stainless steel with GEMPLUX polish finish
- Solid silicone gasket
- One man installation
- Includes grounding screw on nut
- Engineered and built to ABYC specifications



Part #	Pipe	Max. Hull Thickness
GEM 70002	3/4"	1-1/2"
GEM 73003-2	3/4"	5"
GEM 70003	1"	1-7/8"
GEM 70004	1-1/4"	2"
GEM 70005	1-1/2"	2-1/4"
GEM 70006	2"	2-3/8"

Groco Bronze Thru-Hulls

- All bronze castings
- Comes with nut



Part #	NPS Size	Shank Length	Flange Dia.
GRO TH-500-W	1/2"	2-13/64"	1-45/64"
GRO TH-750-W	3/4"	2-13/64"	1-29/32"
GRO TH-1000-W	1"	2-27/32"	2-21/64"
GRO TH-1250-W	1-1/4"	2-29/32"	2-5/8"
GRO TH-1500-W	1-1/2"	3-5/32"	2-57/64"
GRO TH-2000-W	2"	3-29/36"	3-21/64"

Buck Algonquin Thru-Hull Step Wrenches

- Made from plated malleable iron
- Prevents thru-hull turning while nut is tightened



BUC 3BTHW-50-150

Fits 1/2" to 1-1/2" thru-hulls

BUC 3BTHW-20-250

Fits 2" to 2-1/2" thru-hulls

Gemlux Barbed 90° Thru-Hull

- 316 cast stainless
- One man installation
- Uniform head/face design
- Translucent silicon gasket included
- Integrated grounding screw

GEM 78001

5/8"

**Perko Chrome Plated Thru-Hulls**

- Chrome plated cast bronze
- Machined flange to fit hull
- Grooved to retain bedding compound



Part #	Hose	Max. Hull Thickness	OD Flange
PER 350-005-DPC	3/4"	1-5/8"	1-7/8"
PER 350-006-DPC	1"	1-3/4"	2-1/4"

Attwood Plastic Thru-Hull Connectors

- Molded polypropylene
- Use above the waterline
- Hose: 5/8" ID
- Stem length: 3-1/4"
- Max hull thickness: 1-1/4"
- Flange diameter: 1-3/4"
- Cutout hole size: 1-1/8"

ATT 3872-1**Combination Hose**

- Hose: 1-1/8" and 1-1/4" ID
- Stem length: 3-1/4"
- Max hull thickness: 1-1/4"
- Flange diameter: 2-1/4"
- Cutout hole size: 1-3/8"

ATT 3874-3**Attwood Thru-Hull Connectors**

- High impact plastic
- Designed for those hard-to-get-at-places

Part #	Hose Size	Hull Thickness	Flange Dia.	
ATT 3877-1	3/4"	1"	1-1/2"	Bulk
ATT 3877-3	3/4"	1"	1-1/2"	Pkg
ATT 3879-3	1-1/8" to 1-1/4"	1-7/8"	2-7/16"	Pkg

**Perko Plastic Thru-Hulls**

- A molded plastic
- Useful for bait tanks, scuppers, locker drains, bilge discharge, etc
- Not recommended for use below the waterline
- Also available in bulk



Part # (packaged)	Hose	Flange Dia	Hull	Part# (bulk)
PER 328-DP4	1/2"	1-1/2"	1-1/4"	PER 328-004-BULK
PER 328-DP4A	5/8"	1-1/2"	1-1/4"	PER 328-04A-BULK
PER 328-DP5	3/4"	2"	1-5/16"	PER 328-005-BULK
PER 328-DP6	1"	2-1/4"	1-1/2"	PER 328-006-BULK
PER 328-DP6A	1-1/8"	2-1/4"	1-1/2"	PER 328-06A-BULK
PER 328-DP8	1-1/2"	3"	1-7/8"	PER 328-008-BULK

Parts:

PER 326-004	Spare lock nut for 1/2" & 5/8"
PER 326-005	Spare lock nut for 3/4"
PER 326-006	Spare lock nut for 1" & 1-1/8"
PER 326-008	Spare lock nut for 1-1/2"

Rule Thru-Hull

- Made of high impact plastic and will not rust, corrode or discolour
- Designed for Rule 4000 GPH pumps

RUL 72 2" hose**Rule Thru-Hull Connector**

- 5/8" hose connection
- 90° Plastic thru-hull

RUL 62**Sea-Dog Thru-Hull**

- Impervious to electrolysis and corrosion
- For use with hose for drainage above the water line
- Constructed of injection molded polypropylene
- Stem length: 3-1/2"
- Max hull thickness: 1-1/2"
- Cutout hole size: 1"

SED 520750-1 3/4" hose**T-H Marine 90° Thru-Hull**

- Finished head, single pass around nut
- Black polypropylene

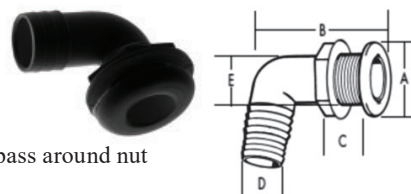

Part #	A	B	C	D	E
THM TH-1290-DP	1-7/8"	3-1/2"	1-1/8"	1-1/8"	1-3/8"
THM TH-1590-DP	2-7/8"	4-1/4"	1-5/8"	1-1/2"	2"



Forespar Thru-Hull Connectors are precision molded in high-strength non-corrosive Marelon. Their great strength, light weight and complete freedom from corrosion and electrolysis make them ideal thru-hull connectors. Available with or without screens.

- NPT threads

Marelon Flush Head Threaded - 250 Series

MPS 906000	1/2"
MPS 906001	1/2" Screened
MPS 906002	3/4"
MPS 906003	3/4" Screened
MPS 906004	1"
MPS 906005	1" Screened
MPS 906006	1-1/4"
MPS 906007	1-1/4" Screened
MPS 906008	1-1/2"
MPS 906009	1-1/2" Screened



Marelon Mushroom Head Threaded - 251 Series

MPS 906010	1/2"
MPS 906011	1/2" Screened
MPS 906012	3/4"
MPS 906013	3/4" Screened
MPS 906014	1"
MPS 906015	1" Screened
MPS 906016	1-1/4"
MPS 906017	1-1/4" Screened
MPS 906018	1-1/2"
MPS 906019	1-1/2" Screened
MPS 906020	2"
MPS 906021	2" Screened



Parts:

MPS 907009	1" thread, replacement nut
-------------------	----------------------------

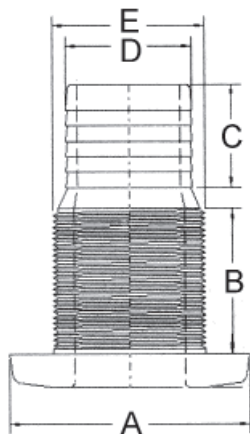
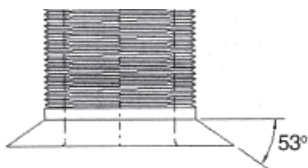

Marelon Mushroom Head Hose Barb - 253 Series

MPS 906022	1/2"
MPS 906023	1/2" Screened
MPS 906024	3/4"
MPS 906025	3/4" Screened
MPS 906026	1"
MPS 906027	1" Screened
MPS 906070	1-1/8"
MPS 906071	1-1/8" Screened
MPS 906028	1-1/4"
MPS 906029	1-1/4" Screened
MPS 906030	1-1/2"
MPS 906032	2"
MPS 906033	2" Screened



Marelon Flush Head Hose Barb - 254 Series

MPS 906038	1-1/4"
MPS 906039	1-5/8"
MPS 906036	1-1/2"
MPS 906037	1-1/2" Screened
MPS 906034	2"
MPS 906035	2" Screened



Series	Size	A	B	C	D	E
250	1/2"	2-3/8"	2"	N/A	N/A	13/16"
	3/4"	2-7/16"	2-1/4"	N/A	N/A	1-1/64"
	1"	2-53/64"	2-3/8"	N/A	N/A	1-9/32"
	1-1/4"	2-53/64"	3"	N/A	N/A	1-41/64"
	1-1/2"	2-13/16"	3"	N/A	N/A	1-27/32"
251	1/2"	1-1/2"	2-1/8"	N/A	N/A	13/16"
	3/4"	2-5/64"	3-3/32"	N/A	N/A	1-1/32"
	1"	2-11/32"	2-13/32"	N/A	N/A	1-9/32"
	1-1/4"	2-21/32"	2-61/64"	N/A	N/A	1-39/64"
	1-1/2"	2-15/16"	2-61/64"	N/A	N/A	1-27/32"
253	1/2"	1-1/2"	1-1/2"	31/32"	43/64"	13/16"
	3/4"	2-7/64"	1-43/64"	1-1/64"	49/64"	1-1/64"
	1"	2-11/32"	1-45/64"	1-3/32"	11/64"	1-9/32"
	1-1/4"	2-43/64"	1-13/64"	1-9/32"	1-17/64"	1-39/64"
	1-1/2"	2-15/16"	1-7/8"	1-9/32"	1-1/2"	1-55/64"
254	2"	3-1/2"	1-7/8"	1-23/64"	2-1/64"	2-21/64"
	1-1/4"	2-51/64"	1-1/2"	1-9/32"	1-17/64"	1-39/64"
	1-1/2"	2-13/16"	1-1/2"	1-9/32"	1-15/32"	1-55/64"
	2"	3-33/64"	1-1/2"	1-5/16"	2-1/64"	2-21/64"

Attwood Composite Thru-Hulls

- Manufactured with high quality stainless steel caps and engineered composite bodies
- Designed to resist degradation as a result of chemical and saltwater exposure
- "Single operator" installation

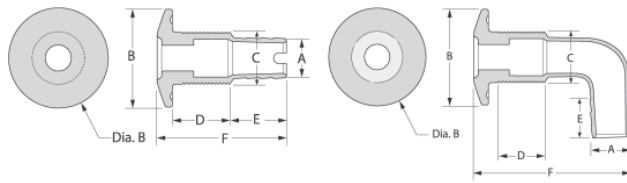

Part #	Style	A (I.D.)	B	C (O.D.)	D	E	F	Install Dia.	Max Hull
ATT 68555-1	Straight	5/8"	1-7/8"	1.29"	1.54"	1"	3.36"	1-3/8"	1.40"
ATT 68554-1	Straight	3/4"	1-7/8"	1.29"	1.54"	1"	3"	1-5/16"	1.40"
ATT 68556-1	Straight	1"	1-7/8"	1.29"	1.54"	1"	3"	1-5/16"	1.40"
ATT 68557-1	Straight	1-1/8"	1-7/8"	1.29"	1.54"	1.32"	2-7/8"	1-5/16"	1.40"
ATT 68551-1	Straight	1-1/2"	2-3/8"	1.55"	1.54"	1.6"	6.09"	1-5/16"	1.40"
ATT 68552-1	Straight	2"	3-1/4"	2.16"	2.09"	1.96"	4.94"	2-1/8"	1.80"
ATT 68576-1	Elbow	5/8"	1-7/8"	1.29"	1.60"	1.27"	3.48"	1-3/8"	1.40"
ATT 68577-1	Elbow	3/4"	1-7/8"	1.29"	1.60"	1.27"	3.48"	1-3/8"	1.40"
ATT 68578-1	Elbow	1"	1-7/8"	1.29"	1.60"	1.27"	3.75"	1-3/8"	1.40"
ATT 68579-1	Elbow	1-1/8"	1-7/8"	1.29"	1.60"	1.5"	3.75"	1-3/8"	1.40"
ATT 68581-1	Elbow	1-1/2"	2-3/8"	1.55"	1.54"	1.5"	3.92"	1-1/2"	1.40"



T-H Marine Thru-Hull

- Hose ID: 1-1/2"
- Length: 3-1/2"
- Maximum hull thickness: 1-3/4"
- Flange diameter: 2-7/8"
- Installation hole diameter: 1-7/8" - 2"
- Black polypropylene



THM TH-1500-DP

T-H Marine Chromed Thru-Hull

- Look of stainless - price of plastic
- Brite Plate Chrome strengthens part
- Hose ID: 1-1/2"
- Length: 3-1/2"
- Maximum hull thickness: 1-3/4"
- Flange diameter: 2-7/8"
- Installation hole diameter: 1-7/8" - 2"
- Above waterline use only



THM TH-1500CP-DP

Attwood

Livewell Connector with Strainer

- Can be used for plumbing or aerator systems
- Strainer keeps seaweed, etc. from entering and clogging pumps
- Hose: 3/4" ID
- Max hull thickness: 1-7/16"
- Cut out hole diameter: 1-1/16"



ATT 3886-3

Marine East Drains

- Flush head w/screen
- White polypropylene is UV resistant and colour stabilized
- 1-5/8" cutout

MEP 6472W 1-1/4"
MEP 6772W 1-1/2"



Marine East L-Head Thru-Hull Drain

- L-head allows total compartment drainage
- UV resistant, colour stabilized
- White polypropylene
- 5/8" hose barb
- 1-1/2" x 1" NPT
- Flange width: 1-29/32"



MEP 6040W

Perko Flush Mount Drains

- Chrome plated cast bronze body with brass screen
- For use with pipe fittings
- The exterior surface of the flange is machined flat and designed to be countersunk into the hull



Part #	Pipe	Max Depth	OD Flange
PER 361-005-CHR	3/4"	2-3/8"	2"
PER 361-007-CHR	1-1/4"	2-15/16"	2-7/8"

Gemlux Cockpit Drain

- Investment cast stainless steel
- Drain installs from the top
- Uses a foam ball to help reduce back-flow when the operator backs up the boat.
- L: 4.13" x W: 3.63" x H: 4.5"
- Hose size: 1-1/2"



GEM 89501

Gemlux**Low Profile Drain**

- Stainless steel cap with a nylon body
- Low profile drain installs from the top
- 1-1/2" hose barb with 3-1/2" cap (2-1/4" cutout)
- Stainless steel top is removable to enable quick cleaning
- Depth: 3"

**GEM 89509****Gemlux****Cockpit Drain**

- Stainless steel cap with a nylon body
- Low profile drain installs from the top
- 1-1/2" hose barb with 3-1/2" cap (2-1/4" cutout)
- Depth: 3.5"

**GEM 89530****Perko Cockpit Drains**

- Plain or chrome plated cast bronze
- Rubber ball backwater check
- For use in sail boats when outlet is below the water line
- Outlet angle is 45°
- Complete with key



Part #	Finish	Hose	OD Grate	OD Flange
PER 142-001-PLB	Bronze	1"	1-13/16"	3-1/4"
PER 142-002-CHR	Chrome	1-1/2"	2-1/4"	3-5/8"

Attwood Bulkhead Connector

- High-impact white plastic
- Hose: 3/4" ID
- Overall length: 5"
- Max hull thickness: 1-1/4"
- Cutout hole diameter: 1-1/8"

**ATT 3878-3****Marine East Bulkhead Fittings**

- Bulkhead fitting reduces hose and cable chafing
- Ideal for hose, cable or wires
- Sizes available to fit marine hoses from 5/8" to 1-1/2"
- Molded of high-strength black engineering plastic for long-term durability

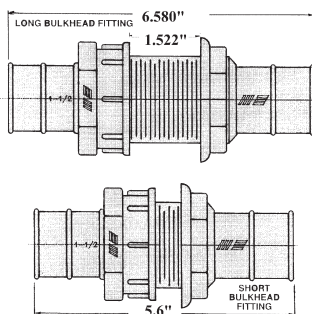

MEP 7900	1-1/2", long
MEP 7910	1-1/2", short
MEP 7920	1-1/4", long
MEP 7930	1-1/4", short
MEP 7940	1-1/8", long
MEP 7950	1-1/8", short
MEP 7960	1", long
MEP 7970	1", short
MEP 7980	3/4"
MEP 7990	5/8"

**Buck Algonquin****Bronze Intake Strainers**

- One-piece, cast bronze, plain finish
- High-speed intake strainer admits full supply of water at all speeds

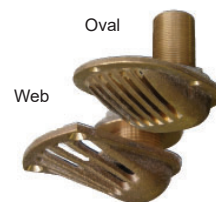

Part #	NPS Size	Stem Length	Base Size	Base
BUC IS-50	1/2"	2-1/2"	2-3/4" x 3-3/4"	Web
BUC IS-75	3/4"	2-1/2"	2-3/4" x 3-3/4"	Web
BUC IS-100	1"	2-1/2"	2-3/4" x 3-3/4"	Web
BUC IS-125	1-1/4"	3"	3-7/8" x 5-3/4"	Oval
BUC IS-150	1-1/2"	3-1/2"	3-7/8" x 5-3/4"	Oval

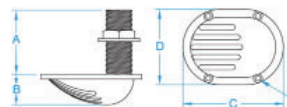
**Groco Bronze Combo Scoop Thru-Hulls**

- Designed for increased flow compared to standard thru hulls
- All bronze castings
- Comes with nut
- NPSM / NPT combination thread

Part #	NPS Size	A	B	C	D
GRO STH-500-W	1/2"	2.20"	1.05"	3.28"	2.55"
GRO STH-750-W	3/4"	2.20"	1.05"	4"	3.05"
GRO STH-1000-W	1"	2.85"	1.05"	4"	3.05"
GRO STH-1250-W	1-1/4"	2.90"	1.20"	4.30"	3.35"

Marelon Thru-Hull Scoop Strainers

- High-strength non-corrosive white Marelon
- Two piece construction allows for greater ease in installation
- Threads: NPT



Part #	Thread	A	B	C	D
MPS 906059	3/4"	1-1/32"	2-1/4"	1"	3-1/8"
MPS 906060	1-1/4"	1-5/8"	2-15/16"	1"	3-3/8"

Parts:

MPS 906061	3/4"	Screen only
MPS 906062	1-1/4"	Screen only

Buck Algonquin**Bronze Scoop Strainers**

- Cast bronze



Part #	Outside Dimensions	Covers Thru-Hulls	Fastener
BUC SS-500	5" x 3-1/4"	3/4"	#8
BUC SS-600	6" x 4"	1"	#8
BUC SS-650	6-1/2" x 4-1/4"	1-1/4"	#8
BUC SS-850	8-1/2" x 5-1/2"	1-1/2" & 2"	#10
BUC SS-1100	10-1/2" x 7-3/8"	2-1/2" & 3"	1/4"

Perko Bronze Scoop Strainer

- Cast bronze
- Use #8 fasteners



Part #	Outside Dimensions	Covers Thru-Hulls
PER 66-DP1-PLB	3-1/2" x 2-1/2"	3/8" & 1/2"

Perko Bronze Round Strainers

- Cast bronze



Part #	Thru Hull	Outside Diameter	Inside Diameter	Screw
PER 86-DP1-PLB	3/8" & 1/2"	2-1/2"	1-5/8"	#8
PER 86-DP2-PLB	3/4"	3"	2"	#8
PER 86-DP3-PLB	1"	3-1/2"	2-3/8"	#8
PER 86-DP4-PLB	1-1/4" & 1-1/2"	4"	3"	#8
PER 86-DP5-PLB	2"	5"	3-3/4"	#8
PER 86-006-PLB	2-1/2"	6"	4-1/2"	#10
PER 86-007-PLB	3"	8"	6-1/4"	#10

Marelon Intake Strainer

- Integral mounting bracket
- Marelon body with clear polycarbonate lid for ready inspection
- Stainless steel strainer basket
- Mounting bracket system allows the strainer body to be turned in any direction
- Ports are 1-1/2" ANP female threads
- Diameter: 6.3" x Height: 6.1"
- Flow rate: 40 GPM

**MPS 906066**

Parts:

MPS 906065*	Stainless steel basket only
MPS 906067	Gasket set
MPS 920178	Cover only
MPS 920179	Knob

* Request Item

Vetus Intake Strainer

- Strainers are provided with a transparent cover, allowing easy inspection of the filter
- Cleaning of the filter can be achieved quickly and easily
- Housing: Polypropylene GF
- Filter element: Polyamide
- Cover: ABS
- Hose: 1-1/8"
- H: 5.75" x Dia: 5.63"

**VTS FILTER150****Vetus Intake Strainers**

- Strainers are provided with a transparent cover, allowing easy inspection of the filter
- Cleaning of the filter can be achieved quickly and easily
- Housing: Polypropylene GF
- Filter element: HD Polyamide
- Cover: Styrol/Acrylnitril SAN
- H: 6.4" x Dia: 5.83"

**VTS FTR330/13** 1/2" hose**VTS FTR330/16** 5/8" hose**VTS FTR330/25** 1" hose**VTS FTR330/32** 1-1/4" hose**VTS FTR330/38** 1-1/2" hose

Parts:

VTS FTR3301 O-ring set & cover**VTS FTR3302** O-ring set**Buck Algonquin Arctic Stainless Steel Intake Water Strainers**

- Electro-polished AISI 2205 stainless steel
- One piece cast construction
- ABS basket
- Cast anode connection point
- Swing down eye bolts
- Drain plug

Bottom In Side Out	Side In Side Out	A	B	C	D	Weight lbs
BUC 70WS-BISO-100-S*	-	5.55"	8.35"	1"	3.74"	7.72
BUC 70WS-BISO-150-S*	BUC 70WS-SISO-150-S*	5.56"	8.35"	1.25"	3.74"	7.72
BUC 70WS-BISO-200-S*	-	8.11"	8.35"	2"	3.74"	7.72
-	BUC 70WS-SISO-250-S*	9.06"	12.95"	2.5"	6.46"	27.56
-	BUC 70WS-SISO-300-S*	9.06"	12.95"	3"	6.46"	27.56

* Request Item

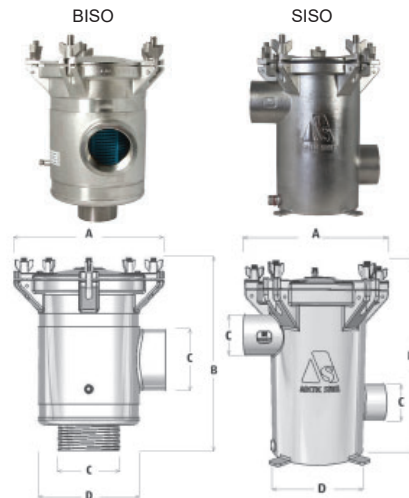

Perko Raw Water Strainers

Perko strainers use outside tie rods to reduce electrolysis. The cast bronze head incorporates wingnut cap tie downs for quick removal and cleaning of the Type 304 stainless steel strainer. Integral mounting lugs on both sides of the top and bottom allow for universal mounting. The cast bronze bottom also incorporates a bronze plug to facilitate winterization. These units are listed by Underwriters Laboratories of the U.S. for marine use.

Part #	Pipe Size	Cylinder	Strainer	Height	Width
PER 493-004-PLB	1/2"	3-1/2" x 4"	1-13/16" x 4-3/8"	5-3/4"	4-1/2"
PER 493-005-PLB	3/4"	3-1/2" x 6"	1-13/16" x 6-1/4"	8-3/8"	4-1/2"
PER 493-006-PLB	1"	4-1/2" x 5-1/2"	2-5/8" x 5-7/8"	9-1/2"	5-1/2"
PER 493-007-PLB	1-1/4"	4-1/2" x 6"	2-5/8" x 6-1/4"	10"	5-1/2"
PER 493-008-PLB	1-1/2"	6" x 8"	3-5/16" x 8-7/16"	11-1/2"	7-1/4"
PER 493-009-PLB	2"	6" x 12"	3-5/16" x 12-1/4"	16"	7-1/2"

Replacement Cover Bolt Assembly	
PER 493-DP5-99L	Cover bolt for 493 #4 + #5
PER 493-DP7-99L	Cover bolt for 493 #6 + #7
PER 493-DP9-99L	Cover bolt for 493 #8 + #9 + #10

Gasket Kits	
PER 493-DP5-99M	Cork 493 #4 + #5
PER 493-DP5-99R	Rubber 493 #4 + #5
PER 493-DP7-99M	Cork 493 #6 + #7
PER 493-DP7-99R	Rubber 493 #6 + #7
PER 493-DP9-99M	Cork 493 #8 + #9 + #10
PER 493-DP9-99R	Rubber 493 #8 + #9 + #10
PER 500-DP9-99M	Cork 500 #9 + #10 #11
Consist of 1 cover gasket and 2 cylinder gaskets	

Replacement Cylinders	
PER 493-004-99C	493 #4
PER 493-005-99C	493 #5
PER 493-006-99C	493 #6
PER 493-007-99C	493 #7
PER 493-008-99C	493 #8
PER 493-009-99C	493 #9
PER 493-010-99C	493 #10

Replacement Basket Strainers	
PER 493-004-99D	493 #4
PER 493-005-99D	493 #5
PER 493-006-99D	493 #6
PER 493-007-99D	493 #7
PER 493-008-99D	493 #8
PER 493-009-99D	493 #9
PER 493-010-99D	493 #10
PER 500-011-99D	500 #11

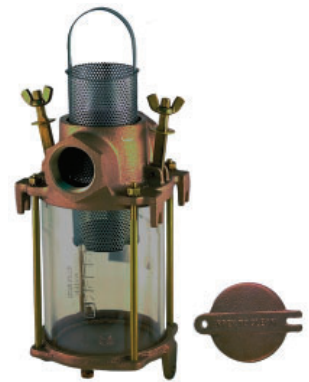

493 Series



500 Series

Marine Hardware Sea Strainer

Flow-through design allows water to tumble horizontally across a stainless steel screen where debris is chopped into small pieces. These pieces, once small enough to pass through the screen, can easily pass through the engine's water system without harm and be exhausted overboard.

- Made of precision machined bronze
- Clear acrylic lens allows for quick inspection
- Drain plug simplifies winter storage
- Inlet: 1-1/4" hose
- Outlets: 2 x 3/4" NPT & 1 x 1" NPT

MHI SEASMPNPTDOME*

Parts:

MHI SEAS-3GASKETS

MHI SEAS-LENS-DOME

MHI SEAS-LENS

* Request Item

3 pc. gasket set
Domed - clear lid only
Acrylic flat lens (old style)



Marine Hardware Universal Mount Sea Strainer

- Cast bronze housing
- Pull out strainer screen assembly
- Plastic bowl is securely fastened to the manifold with a bronze retainer ring plate
- Design ensures a firm mount to the engine stringer and allows full 360° rotation of the top housing
- For left and right hand engine installations
- H: 13.68" x W: 8.25"
- 2" NPT ports

MHI SEAS-UM-200SM

Parts:

MHI SEASSCREEN-2.000

MHI SEASBOWL200/250

Replacement screen

Replacement bowl



Groco ARG Series Raw Water Strainers

The ARG series of strainers uses a one-piece sight glass, eliminating tie rods and bottom end cap. The cast bronze or stainless steel head has a spin off cap allowing easy cleaning of the stainless steel basket. The cap and sight glass are sealed to the head with Buna-N O-rings. The quick mounting system allows for removal of the strainer without tools. These units are listed by Underwriters Laboratories of the US for marine use. The female pipe connection size is indicated by the part number, i.e., ARG 1250 is 1-1/4".

Part #	Material	Pipe	A	B	C	D	Ratio	lbs
GRO ARG-500-S	Bronze	1/2"	6.4	4.5	5.3	1.5	54	3.5
GRO ARG-750-S	Bronze	3/4"	8.4	4.5	5.3	1.5	36	3.7
GRO ARGS-755-S	Stainless							3.4
GRO ARG-1000-S	Bronze	1"	9.0	5.8	6.5	2.0	28	5.8
GRO ARGS-1000-S	Stainless							6.0
GRO ARGS-1210-S	Stainless	1-1/4"	9.2	5.8	6.5	2.3	18	6.1
GRO ARG-1250-S	Bronze	1-1/4"	10.6	5.8	6.5	2.3	24	6.4
GRO ARG-1500-S	Bronze	1-1/2"	11.4	7.3	7.8	2.5	20	9.6
GRO ARGS-1500-S	Stainless							10.0
GRO ARG-2000-S	Bronze	2"	14.0	7.3	7.5	2.8	14	12.2
GRO ARG-2500-S	Bronze	2-1/2"	17.0	7.3	7.8	3.1	11	14.2
GRO ARG-3000-S	Bronze	3"	19.8	7.3	7.8	3.5	9	17.3



ARGS
Stainless series



Groco Service Kits (Dia. #2)

Includes:

- 5 x #5 washer
- 1 x #12 O-ring
- 1 x #13 O-ring
- 1 x #14 O-ring
- 1 x #15 O-ring

GRO ARG-1 Service kit

GRO ARG-2 Service kit

GRO ARG-3 Service kit

Parts:

GRO ARG-756 Drain nut & washer

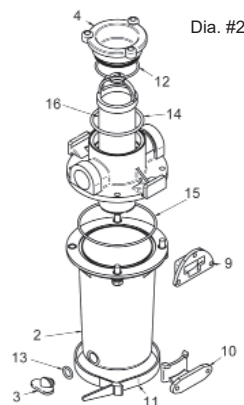

Dia. #2

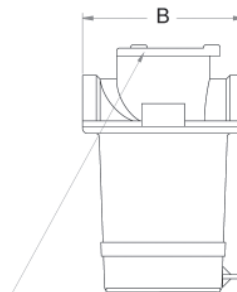

UNSCREW COVER TO SERVICE BASKET

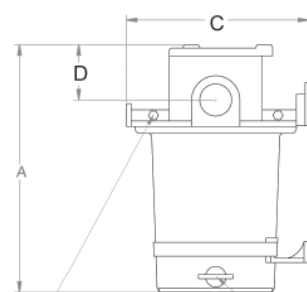

BONDING ATTACHMENT BOTH SIDES, TYP.

UNSCREW PLUG TO DRAIN

Part #	ARG 500-S	ARG 750-S	ARG 1000-S	ARG 1250-S	ARG 1500-S	ARG 2000-S	ARG 2500-S	ARG 3000-S
S/S Basket (16)	BS-1	BS-2	BS-3	BS-5	BS-6	BS-8	BS-11	BS-15
Monel Basket (16)	BM-1*	BM-2	BM-3	BM-5*	BM-6*	BM-8	BM-11*	BM-15*
Poly Basket (16)	BP-1*	BP-2*	BP-3*	BP-5*	BP-6*	BP-8*	BP-11*	BP-15*
Sight Glass (2)	ARG-503	ARG-753	ARG-1003	ARG-1253	ARG-1503	ARG-2003	ARG-2503	ARG-3003
Glass O-ring (15)	2-153	2-153	2-157	2-157	2-256	2-256	2-256	2-256
Cap O-ring (12)	2-228	2-228	2-232	2-232	2-238	2-238	2-238	2-238
O-ring (14)	N/A	N/A	2-229*	2-229*	2-234*	2-234*	2-234*	2-234*
Strap (11)	ARG-502	ARG-502	ARG-502	ARG-502	ARG-1502*	ARG-1502*	ARG-1502*	ARG-1502*
Drain Nut (3) Pre 2001	ARG-506	ARG-506	ARG-506	ARG-506	ARG-506	ARG-506	ARG-506	ARG-506
Drain Nut (3) Post 2001	ARG-756	ARG-756	ARG-756	ARG-756	ARG-756	ARG-756	ARG-756	ARG-756
Lower Bracket (10)	ARG-504	ARG-504	ARG-1004	ARG-1004	ARG-1504*	ARG-1504*	ARG-1504*	ARG-1504*
Upper Bracket (11)	ARG-505	ARG-505	ARG-1005	ARG-1005	N/A	N/A	N/A	N/A
Top Cap-Plastic (4)	N/A	ARG-501-PC	ARG-1001-PC	ARG-1001-PC	ARG-1501-PC	ARG-1501-PC	ARG-1501-PC	ARG-1501-PC
Kit Part #	ARG-1	ARG-1	ARG-2	ARG-2	ARG-3	ARG-3	ARG-3	ARG-3

* Request Item

Groco Service Kits for SA Series Strainers

Kit contains 2 each cylinder gaskets, 1 each nut cover gasket and 1 each wing nut washer.

GRO SA-2 SA-1000/SA-1250

GRO SA-3 SA-1500/SA-2000/SA-2500/SA-3000

All Groco baskets have an improved design, incorporating a series of knockouts making them compatible with the ARG, SA, VD and 932 series strainers.

Marine Hardware**Brass Garboard Drain Plug**

- Cast brass with a 1/2" NPT square head plug
- 1-7/8" dia. flange
- 3/8" spigot
- Use #8 fasteners

**MHI GARB-0.500-P****Perko Garboard Drain Plug**

- Bronze with machined 1/2" NPT plug
- UL Listed
- 2" dia. flange
- 1/2" spigot
- Use #8 fasteners

**PER 714-DP1-PLB****Sea-Dog Bronze Garboard Drain Plugs**

- Machined bronze
- 2" diameter with 1/2" NPT plug

SED 520040-1 Complete set
SED 520041-1 Replacement plug



- POP display with 30 replacement plugs

SED 520041-5 Plug, bulk**Sea-Dog Garboard Drain T-Handle Plug**

- Die cast bronze
- Pipe size: 3/4" NPT
- Overall length: 3-1/2"

**SED 520047-1****Perko Garboard Drain Plug**

- Cast bronze, thru-hull style garboard drain
- Maximum hull thickness 3/4"
- Pipe size: 3/4"
- Length of threaded neck: 1-1/4"
- OD flange: 2-3/8"

**PER 363-DP-PLB**

Parts:

PER 370-DP-PLB Spare plug**Marelon Garboard Drain**

- Drain and screw plug assembly
- Fits up to 1-3/4" thick applications
- Made of precision molded Marelon
- 3/4 Thread, flange: 2", cutout: 1"

MPS 906081**Sea-Dog Garboard Drain**

- Flange: 2-3/16", Length: 2-3/16", Pipe: 1-1/8"
- Injection molded nylon
- Use #8 FH fasteners

SED 520050-1 Drain/plug
SED 520051-1 Replacement plug

**Sea-Dog Plugmate Garboard Wrench**

- Injection molded polypropylene fibreglass
- Fits most standard and "T" style garboard plugs
- In addition, it has various deck plate keys and a shackle key
- Includes a replacement plug #520041

SED 520045-1**Sea-Dog Captive Garboard Drain Plug**

- Investment cast 316 stainless steel
- A direct replacement for the traditional style bronze garboards
- Captive plug means no more lost plug
- 2" dia x 2-5/8" deep

SED 520060-1**Sea-Dog Oblong Captive Garboard Drain Plug**

- Investment cast 316 stainless steel construction
- Sits low in the seam for complete water removal
- 2-7/16" width x 2-5/8" deep

SED 520065-1**Marelon Drain Plug**

- Typically used for transom drains
- Molded in high-strength non-corrosive Marelon
- Fitted with a neoprene seal and stainless steel retainer
- 1" cutout

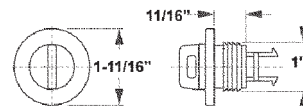
MPS 907001**Sea-Dog Drain Plug**

- Fits securely in a 1" hole without the use of fasteners
- The ridges on the body of the drain plug are designed to keep the plug in place
- Sealant should be applied prior to installation to make a watertight seal

SED 520030-1 Injection molded nylon
SED 520021-1 Replacement plug



Sea-Dog Drain Plugs

Molded in captive mechanism keeps the plug in the body but still allows for easy removal when required.

- Use #10 FH

SED 520010-1	Injection molded nylon
SED 520020-1	Chrome brass base/nylon plug
SED 520021-1	Replacement plug

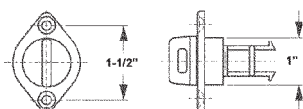

T-H Marine Push-In Plug

- Injection molded black plug
- Large ring for easy removal
- Double ring seal design is used to stop water flow through drains from baitwell or livewell tanks

THM PP-150-DP 1-1/2"



Sea-Dog

Emergency Garboard Drain Plug

- Features an attached key ring
- Fits most 1/2" NPT threaded drains
- Injection molded nylon

SED 520059-1	2/pkg
SED 520059-5	Display pkg/30



Sea-Dog Snap Handle Drain Plugs

- Stamped brass, stainless steel or aluminum

SED 520070	1" Brass
SED 520070-1	1" Brass
SED 520071-1	1" Brass w/chain
SED 520072	1-1/4" Brass
SED 520072-1	1-1/4" Brass
SED 520075-1	1" Stainless steel
SED 520075	1" Stainless steel

Suffix (-1) indicates display package

- POP display with 25 brass snap plugs

SED 520070-5	1" Brass, bulk
---------------------	----------------

- POP display with 20 stainless snap plugs

SED 520075-5	1" Stainless, bulk
---------------------	--------------------



Sea-Dog T-Handle Drain Plugs

Stamped brass, stainless steel or aluminum.

SED 520080	1" Brass
SED 520080-1	1" Brass
SED 520085-1	1" Stainless steel
SED 520086-1	1-1/4" Stainless steel

Suffix (-1) indicates display package

- POP displays with drain plugs

SED 520080-5	1" Brass, 30/pkg
SED 520085-5	1" Stainless, 20/pkg



Sea-Dog Baitwell Plugs

- Stamped brass, neoprene plug

Part #	Dia.	Packaging
SED 520091	3/8"	Bulk
SED 520091-1	3/8"	2/pkg
SED 520092	1/2"	Bulk
SED 520092-1	1/2"	2/pkg
SED 520093	5/8"	Bulk
SED 520093-1	5/8"	2/pkg
SED 520094	3/4"	Bulk
SED 520094-1	3/4"	2/pkg
SED 520095	7/8"	Bulk
SED 520095-1	7/8"	2/pkg

Suffix (-1) indicates display package



Marelon Well Drain

- Precision molded from acetyl resin (Delrin)
- Can also be used for other applications such as a chafe guard to lead hose, wiring, steering cables, etc. through bulkheads, floor timbers and fiberglass panels
- Barbs on OD ensure positive locking action
- Cutout: 1" x Flange 1-1/4" dia. x L: 2-1/2"

MPS 907006



Gemlux Well Drain

- Cross-bar keeps the drain clear of trash that can clog other splash well drains
- Stainless steel endcaps and plastic tube
- D: 1.25" x L: 5.38" x Flange: 1.875"

GEM 73100



Sea-Dog Drain Flaring Tools

- Drain tube flaring tool
- Use to install brass or aluminum drain tubes
- Stainless steel/zinc plated steel construction

SED 520290-1	1" tube
SED 520295-1	1-1/4" tube

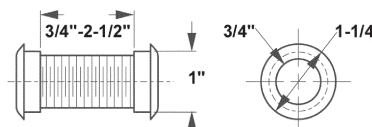

Sea-Dog Drain Tube

- Injected molded nylon

SED 520320-1



Sea-Dog Drain Tubes

- Formed brass tube

SED 520210	1" x 1-7/8"
SED 520210-1	1" x 1-7/8"
SED 520220-1	1" x 2-3/8"
SED 520230-1	1" x 2-7/8"

Suffix (-1) indicates display package



T-H Marine 90° Drain

- Molded white 90° drain
- Mounts in a 1-3/8" dia. hole
- Secured with retaining nut
- Hose barb for 3/4" hose

THM APD-290F-DP Flat head

Buck Algonquin
Stainless Pipe to Hose Adapters

- Cast 316 stainless steel male pipe thread to hose connectors

BUC RN-33	3/8"
BUC RST-1	1/2"
BUC RST-5	3/4"
BUC RST-10	1"
BUC RST-15	1-1/4"
BUC RST-20	1-1/2"
BUC RST-25	2"
BUC RST-30	2-1/2"

Buck Algonquin
Bronze Pipe to Hose Adapters

- Cast bronze male pipe thread to hose connector

Part #	Pipe	Hose
BUC HN-50	1/2"	1/2"
PER 76-DP4-PLB	1/2"	5/8"
BUC HN-75	3/4"	3/4"
BUC HN-75100	3/4"	1"
BUC HN-100	1"	1"
BUC HN-125	1-1/4"	1-1/4"
BUC HN-150	1-1/2"	1-1/2"
BUC HN-150-5	1-1/4"	1-1/2"
BUC HN-200	2"	2"
BUC HN-250	2-1/2"	2-1/2"
BUC HN-300	3"	3"

Groco
Bronze Pipe to Hose Full Flow Adapters

- Cast bronze male pipe thread to hose connector
- Full flow adapters provide a larger internal diameter, with the same external specs for superior flow

Part #	Pipe	Hose
GRO FF-500	1/2"	3/4"
GRO FF-750	3/4"	1"
GRO FF-1000	1"	1-1/4"
GRO FF-1125	1"	1-1/8"
GRO FF-1250	1-1/4"	1-1/2"
GRO FF-1500	1-1/2"	1-3/4"
GRO FF-2000	2"	2-1/4"

Buck Algonquin
90° Street Elbow

- Bronze

GRO STREET ELL-2	1/2"
GRO STREET ELL-18	3/4"
GRO STREET ELL-3	1"
GRO STREET ELL-4	1-1/4"
GRO STREET ELL-9	1-1/2"

Buck Algonquin
90° Pipe to Hose Adapters

- Cast bronze, 90° elbow male pipe thread to hose connector

BUC HN-75-E	3/4"
BUC HN-100-E	1"
BUC HN-125-E	1-1/4"
BUC HN-150-E	1-1/2"
BUC HN-200-E	2"
BUC HN-250-E	2-1/2"
BUC HN-300-E	3"

**Groco Bronze Pipe To Hose 90°**

- Full flow
- All bronze castings

Part #	Pipe	Hose
GRO FFC-750	3/4"	1"
GRO FFC-1250	1-1/4"	1-1/2"

**Groco Bronze Pipe To Hose Adapters**

- All bronze castings
- NPT thread

Part #	Pipe	Hose
GRO PTH-500	1/2"	1/2"
GRO PTH-5062	1/2"	1/2" or 5/8"
GRO PTH-750	3/4"	3/4"
GRO PTH-1000	1"	1"
GRO PTH-1125	1-1/4"	1-1/8"
GRO PTH-1250	1-1/4"	1-1/4"
GRO PTH-1500	1-1/2"	1-1/2"
GRO PTH-2000	2"	2"



PTH-5062

Groco 90° Pipe to Hose Adapters

- Bronze standard flow

Part #	Pipe	Hose
GRO PTHC-5062	1/2"	1/2" or 5/8"
GRO PTHC-750	3/4"	3/4"
GRO PTHC-1000	1"	1"
GRO PTHC-1250	1-1/4"	1-1/4"
GRO PTHC-1500	1-1/2"	1-1/2"
GRO PTHC-2000	2"	2"



PTHC-5062



PTHC-1000

Groco 45° Male Pipe to Hose Adapters

- Bronze standard flow

Part #	Pipe	Hose
GRO PTHD-750	3/4" NPT	3/4"
GRO PTHD-1000	1" NPT	1"
GRO PTHD-1250	1-1/4" NPT	1-1/4"
GRO PTHD-1500	1-1/2" NPT	1-1/2"

**Groco Pipe Nipples**

- Bronze full flow
- Cast-in wrench flat

GRO PN-500	1/2"
GRO PN-750	3/4"
GRO PN-1000	1"
GRO PN-1250	1-1/4"
GRO PN-1500	1-1/2"
GRO PN-2000	2"



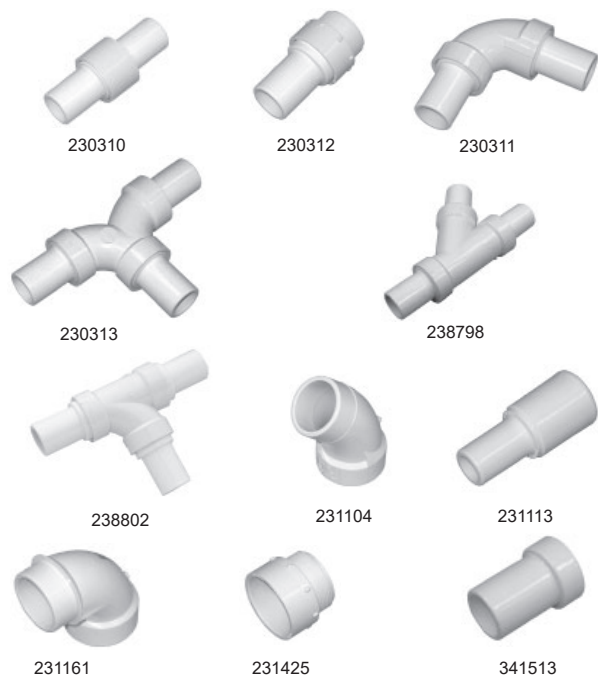

Sealand PVC Hose Fittings

These 1-1/2" hose barbs are smooth on the outside which makes for a better seal between the hose and the fitting, and allow removal of the hose for servicing the plumbing system. All fittings require priming and gluing except for part numbers with the 'A' suffix which are pre-assembled and ready for use.

SLD 341513	1-1/2" Custom hose adaptor
SLD 231104	45° Street elbow
SLD 231425	Use with hose adaptor or PVC pipe
SLD 231161	90° street elbow
SLD 230312	Hose adaptor includes 341513
SLD 230312-A	Adaptor includes 341513
SLD 230311	90° sweep elbow includes adaptors
SLD 230311-A	90° sweep elbow includes adaptors
SLD 230310	Hose mender kit
SLD 238802	Tee kit includes adaptors
SLD 238802-A	Tee kit includes adaptors
SLD 230313	Double bend kit includes adaptors
SLD 238798	"Y" kit includes adaptors
SLD 238798-A	"Y" kit includes adaptors
SLD 231113**	Reducing adaptor 1-1/2" - 1"

A Suffix parts are pre-assembled

** Non PVC part, cannot be glued

Attwood Hose Connectors

- 90° or straight hose-to-thread connector
- Barbed end accommodates 3/4" ID hose
- Acetal construction

ATT 3890-1	90°, 3/4-14 thread
ATT 3899-3	Straight, fits 3/4" FNPT



Tuff-Lite Nylon 'T' Hose Fittings

- Light and durable nylon fittings

TLF TSSS 222	1/4"
TLF TSSS 333	3/8"
TLF TSSS 444	1/2"
TLF TSSS 666	3/4"



Tuff-Lite Nylon Male Pipe to Hose Adapters

- Light and durable nylon fittings

Part #	Hose	MPT
TLF TN 22	1/4"	1/4"
TLF TN 23	1/4"	3/8"
TLF TN 33	3/8"	3/8"
TLF TN 34	3/8"	1/2"
TLF TN 44	1/2"	1/2"
TLF TN 46	1/2"	3/4"
TLF TN 54	5/8"	1/2"
TLF TN 56	5/8"	3/4"
TLF TN 64	3/4"	1/2"
TLF TN 66	3/4"	3/4"
TLF TN 68	3/4"	1"
TLF TN 86	1"	3/4"
TLF TN 88	1"	1"
TLF TN 150	1-1/4"	1-1/4"
TLF TN 2015	1-1/2"	1-1/4"
TLF TN 200	1-1/2"	1-1/2"
TLF TN 250	2"	2"



Tuff-Lite Nylon 90° Male Pipe to Hose Adapters

- Light and durable nylon fittings

Part #	Hose	MPT
TLF TLS 21	1/4"	1/8"
TLF TLS 22	1/4"	1/4"
TLF TLS 32	3/8"	1/4"
TLF TLS 33	3/8"	3/8"
TLF TLS 44	1/2"	1/2"
TLF TLS 46	1/2"	3/4"
TLF TLS 48	1/2"	1"
TLF TLS 54	5/8"	1/2"
TLF TLS 56	5/8"	3/4"
TLF TLS 66	3/4"	3/4"
TLF TLS 86	1"	3/4"
TLF TLS 88	1"	1"



Tuff-Lite Nylon Hose to Hose Fittings

- Light and durable nylon fittings

TLF TM 3	3/8"
TLF TM 4	1/2"
TLF TM 5	5/8"
TLF TM 6	3/4"
TLF TM 8	1"
TLF TM 16	1-1/4"
TLF TM 21	1-1/2"
TLF TM 26	2"



Tuff-Lite Nylon 'T' Hose x Hose x MPT Fittings

- Light and durable nylon fittings

TLF TSST 444	1/2"
---------------------	------



Shields Hose Connectors



- Fibreglass reinforced nylon fittings designed to fit series 101, series 105, series 144, and series 148 hoses without heating or special tools
- Chemical and fuel resistant and will not cause electrolysis
- Primarily used in sanitation systems, deck drain systems and water tank fill

SHI N800-1120B	Straight male, 1-1/2" MPT x 1-1/2" hose
SHI N801-1120	Straight female, 1-1/2" FPT x 1-1/2" hose
SHI N802-1120	90° male, 1-1/2" MPT x 1-1/2" hose
SHI N803-1120	90° female, 1-1/2" FPT x 1-1/2" hose
SHI N806-1120	Tee 1-1/2" hose

Marelon 90° Male Pipe to Hose Adapters

- Threads: NPSM

Part #	A	B	C	D	E
MPS 901000	1/2"	5/8"	7/16"	2"	1-1/2"
MPS 901001	3/4"	3/4"	1/2"	2-1/8"	1-5/8"
MPS 901002	1"	1"	5/8"	2-1/2"	1-7/8"
MPS 901003	1-1/4"	1-1/4"	7/8"	2-3/4"	2-5/16"
MPS 901004	1-1/2"	1-1/2"	1-1/16"	3-1/4"	2-3/4"
MPS 901005	2"	2"	1-1/2"	3-5/8"	3-1/4"

Marelon 90° Female Pipe to Hose Adapters

- Threads: NPSF

Part #	A	B	C	D	E
MPS 901006	1/2"	5/8"	7/16"	2"	1-5/8"
MPS 901007	3/4"	3/4"	9/16"	2-3/16"	1-3/4"
MPS 901008	1"	1"	5/8"	2-1/2"	1-7/8"
MPS 901009	1-1/4"	1-1/4"	7/8"	2-3/4"	2-1/2"
MPS 901010	1-1/2"	1-1/2"	1-1/8"	3-1/8"	2-3/4"
MPS 901011	2"	2"	1-9/16"	3-5/8"	3-1/4"

Marelon 'Y' Connectors

- End plates may be removed for blockage relief
- O-ring seal for working pressures up to 80 PSI
- Available with or without mounting flange

MPS 902002	1" hose w/flange
MPS 902004	1-1/2" hose w/flange
MPS 902005	1-1/2" hose, no flange

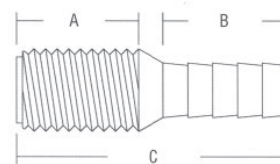

Marelon Male Pipe to Hose Adapters

- Threads: NPSM

Part #	Thread	Tailpipe	A	B	C
MPS 905006	1/2"	5/8"	1"	1"	2-1/4"
MPS 905007	3/4"	3/4"	1"	1"	2-3/8"
MPS 905008	1"	1"	1-1/2"	1-1/16"	2-7/8"
MPS 905009	1-1/4"	1-1/4"	1-5/8"	1-1/4"	3-1/4"
MPS 905010	1-1/2"	1-7/16"	1-7/16"	1-1/8"	2-5/8"
MPS 905011	2"	2"	1-11/16"	1-1/4"	3-1/4"
MPS 905016	1"	1-1/8"	1"	1-1/16"	2-7/8"

Marelon Tapered Pipe to Hose Adapters

Part #	Pipe	Hose
MPS 910146	1/4"	1/4"
MPS 910147	1/4"	5/16"
MPS 910148	1/4"	3/8"
MPS 910149	1/4"	1/2"
MPS 910150	3/8"	3/8"
MPS 910154	3/8"	1/2"
MPS 910156	1/2"	1/2"
MPS 910157	1/2"	3/4"
MPS 910158	3/4"	1/2"
MPS 910159	3/4"	3/4"
MPS 910160	3/4"	1"
MPS 910168	1-1/4"	1-1/2"



Marelon Reducer/Adapters

- Female pipe to female pipe, NPSF threads

MPS 901042	FTC 1" female
MPS 901043	FTC 1-1/2" female
MPS 901044	FTC 1-1/4" female
MPS 901045	FTC 1/2" female
MPS 901046	FTC 3/4" female



901046

- Male pipe to male pipe, NPSM

MPS 901040	MTC 3/4" - 1/2" male
MPS 901048	MTC 1-1/2" - 1-1/4" male
MPS 901049	MTC 1-1/2" - 1-1/2" male
MPS 901050	MTC 3/4" - 3/4" male
MPS 901051	MTC 1" - 3/4" male



901051

- Male pipe to female pipe, NPSM-NPSF

MPS 910062	RB 1-1/2" male - 1" female
MPS 910063	RB 1-1/2" male - 3/4" female



910063

Marine East**MPT To MPT Adapters**

- Molded of high-strength engineered composite
- Max continuous heat: 210F°

Part #	MPT	MPT
MEP 8950	1/2"	1/2"
MEP 8951	1/2"	3/4"
MEP 8952	1/2"	1"
MEP 8960	3/4"	3/4"
MEP 8961	3/4"	1"
MEP 8963	3/4"	1-1/4"
MEP 8970	1"	1"
MEP 8973	1"	1-1/2"
MEP 8990	1-1/4"	1-1/4"
MEP 8991	1-1/4"	1-1/2"
MEP 8995	1-1/2"	1-1/2"

**Marine East****FPT To FPT Adapter**

- Molded of high-strength engineered composite
- Max continuous heat: 210F°

MEP 8700	1/2" x 1/2"
MEP 8720	1-1/2" x 1-1/2"

**Marine East****Plastic Female Pipe to Hose Adapters**

- Molded of high-strength engineered composite
- Max continuous heat: 210F°

Part #	FPT	Hose
MEP 8750	1/2"	5/8"
MEP 8751	1/2"	3/4"
MEP 8752	1/2"	1"
MEP 8010	3/4"	5/8"
MEP 8758	3/4"	5/8"
MEP 8760	3/4"	3/4"
MEP 8761	3/4"	1"
MEP 8762	3/4"	1-1/8"
MEP 8770	1"	1"
MEP 8771	1"	1-1/8"
MEP 8772	1"	1-1/4"
MEP 8775	1-1/4"	3/4"
MEP 8776	1-1/4"	1"
MEP 8782	1-1/4"	1-1/2"
MEP 8778	1-1/2"	5/8"
MEP 8779	1-1/2"	3/4"
MEP 8783	1-1/2"	1"
MEP 8784	1-1/2"	1-1/8"
MEP 8785	1-1/2"	1-1/4"
MEP 8786	1-1/2"	1-1/2"

**Marine East****Plastic Male Pipe to Hose Adapters**

- Molded of high-strength engineered composite
- Max continuous heat: 210F°

Parts	MPT	Hose
MEP 8900	1/2"	5/8"
MEP 8901	1/2"	3/4"
MEP 8905	1/2"	1-1/2"
MEP 8910	3/4"	5/8"
MEP 8911	3/4"	3/4"
MEP 8912	3/4"	1"
MEP 8913	3/4"	1-1/8"
MEP 8920	1"	5/8"
MEP 8921	1"	3/4"
MEP 8922	1"	1"
MEP 8923	1"	1-1/8"
MEP 8924	1"	1-1/4"
MEP 8925	1"	1-1/2"
MEP 8931	1-1/4"	3/4"
MEP 8932	1-1/4"	1"
MEP 8933	1-1/4"	1-1/8"
MEP 8934	1-1/4"	1-1/4"
MEP 8935	1-1/4"	1-1/2"
MEP 8940	1-1/2"	5/8"
MEP 8941	1-1/2"	3/4"
MEP 8942	1-1/2"	1"
MEP 8943	1-1/2"	1-1/8"
MEP 8944	1-1/2"	1-1/4"
MEP 8945	1-1/2"	1-1/2"

**Marine East****Plastic Male Pipe To Hose Adapters**

- Molded of high-strength engineered composite
- Max continuous heat: 210F°

Part #	Hose ID	Thread
MEP 8001	5/8"	1/2" MPT
MEP 8002	3/4"	3/4" MPT
MEP 8003	1"	1" MPT
MEP 8005	1-1/2"	1-1/2" MPT

**Marine East Plastic Hose Fittings**

8070



8080

- Angled T fittings

MEP 8070	1-1/2" Barbed angled T
MEP 8080	1-1/2" Barbed angled T, with one end threaded

Marine East MaxxFlow 100° Angled Elbows

- 100° angle minimizes chances of clogging
- Standard tapered American pipe threads
- Low profile design maximizes uses
- Molded rugged nylon for strength and durability
- For use in sanitation systems



Part #	Hose ID x B
MEP 8019	5/8" hose to 1/2" FPT
MEP 8058	1-1/2" hose to 1-1/2" FPT
MEP 8022	3/4" hose to 3/4" MPT
MEP 8057	1-1/2" hose 1-1/2" MPT (short thread)
MEP 8060	1-1/2" hose 1-1/2" MPT (long thread)
MEP 8034	1" hose to 1" hose
MEP 8059	1-1/2" hose to 1-1/2" hose

Marine East Plastic Hose Adapters

- Molded of high-strength engineered composite
- Max continuous heat: 210F°

Part #	Hose	Hose
MEP 8800	5/8"	5/8"
MEP 8805	5/8"	3/4"
MEP 8810	5/8"	1"
MEP 8815	5/8"	1-1/8"
MEP 8820	5/8"	1-1/4"
MEP 8825	5/8"	1-1/2"
MEP 8830	3/4"	3/4"
MEP 8835	3/4"	1"
MEP 8840	3/4"	1-1/8"
MEP 8845	3/4"	1-1/4"
MEP 8850	3/4"	1-1/2"
MEP 8855	1"	1"
MEP 8860	1"	1-1/8"
MEP 8865	1"	1-1/4"
MEP 8870	1"	1-1/2"
MEP 8875	1-1/8"	1-1/8"
MEP 8880	1-1/8"	1-1/4"
MEP 8885	1-1/8"	1-1/2"
MEP 8890	1-1/4"	1-1/4"
MEP 8895	1-1/4"	1-1/2"
MEP 8899	1-1/2"	1-1/2"



Marine East Threaded Plugs

- Standard tapered pipe thread
- Molded of high-strength engineered composite
- Max continuous heat: 210F°

MEP 4245	3/4" MPT
MEP 4250	1" MPT
MEP 4255	1-1/4" MPT
MEP 4260	1-1/2" MPT



Marine East Threaded Caps

- Standard tapered pipe thread
- Molded of high-strength engineered composite
- Max continuous heat: 210F°

MEP 4275	3/4" FPT
MEP 4280	1" FPT
MEP 4285	1-1/4" FPT
MEP 4290	1-1/2" FPT



Vetus Hose Connectors

- Synthetic hose pillars
- Simply cut to size
- Ideal for securely joining two dissimilar ID hoses

VTS HA1338	1/2" to 1-1/2"
VTS HA3060	1-3/16" to 2-23/64"



Sea Tech Inc., a subsidiary of Watts Water Technologies, was established in 1995 and provides reliable, high quality, cost effective connection solutions. Sea Tech Inc. offers a wide range of standard and unique custom fittings, valves, manifolds, and tubing designed to address specific customer requirements. As a subsidiary of Watts, Sea Tech Inc. designs, manufactures, and markets its products worldwide from Wilmington, NC and through authorized stocking distributors. Sea Tech Inc. maintains a continual R&D program to constantly upgrade the product ensuring the most reliable, cost effective solution for your connection needs. It is Sea Tech's mission to provide customers the best product available, with on-time delivery, at the best possible price.

MATERIAL SPECIFICATIONS

SERIES	MATERIAL	COLOR	O-RING
10 Series	Polypropylene	White	EPDM
24 Series	Thermal Plastic	Bright White	EPDM
35 Series	High Performance Thermal Plastic	Off White	EPDM
45 Series	Brass	Brass	EPDM
Metric Series	Thermal Plastic	Black	EPDM

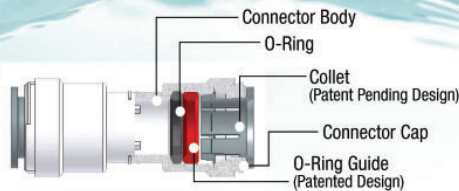

FITTING PERFORMANCE RATINGS

10 Series	60psi@140°F 4bar@60°C	150psi@70°F 10.3bar@20°C Minimum 33°F/1°C
24 Series	100psi@140°F 6.8bar@60°C	250psi@75°F 17.25bar@24°C
35 Series	100psi@180°F 6.8bar@82°C	250psi@75°F 17.25bar@24°C
45 Series	200psi@180°F 13.6bar@82°C	250psi@75°F 17.25bar@24°C
Metric Series	100psi@140°F 6.8bar@60°C	250psi@75°F 17.25bar@24°C

THREAD TORQUE VALUES

Size	1/2"	3/4"
Torque	Min. 17.7 in-lbs	Min. 22.7 in-lbs
Value	Max. 26.5 in-lbs	Max. 31 in-lbs

TUBING TOLERANCES

Tolerance	+0.004" ~ 0.004" O.D. +.010mm ~ -.010mm O.D.
-----------	---

FDA FDA approval:
Sea Tech fittings are produced
from FDA approved materials.

CSA CSA B137.5 Certifications:
Sea Tech 35 Series and
45 Series products are tested,
certified, and approved to
Canadian standard CSA B137.5.

NSF ANSI/NSF-61 Certifications:
Sea Tech 10 Series, 24 Series,
35 Series, 45 Series and
Metric Series products are
tested, certified, and approved
for contact with drinking water.

ASTM ASTM F877 Certifications:
Sea Tech 35 Series and
45 Series products are tested,
certified, and approved to
ASTM F877 performance
standards.

NSF ANSI/NSF-14 Certifications:
Sea Tech 35 Series and
45 Series products are tested,
certified, and approved to
NSF-14 standards.

NSF NSF-U.P. Code Certifications:
Sea Tech 35 Series and 45 Series
products are tested, certified,
and approved and meet the
requirements of the Uniform
Plumbing Code.

Technical Information

MAKING A CONNECTION

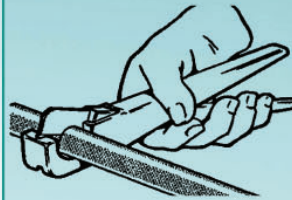

Cut the tubing to length using the Sea Tech tubing cutter or similar. Inspect the outside diameter of the tubing. It must be free of damage, smooth, and clean.

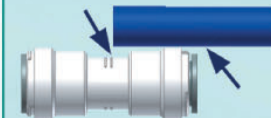

Measure the insertion depth on the tubing end. Sea Tech connectors have a insertion depth line molded onto the outside of the connector bodies.

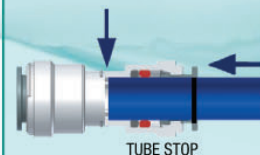

Make certain to push the tubing completely into the connector until it comes into contact with the internal tubing stop.

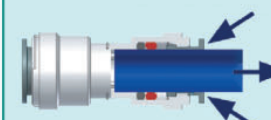

To disconnect ensure the system is depressurized before removing connectors. Push the collet in squarely against the face of the fitting. With the collet held in this position, the tubing can be removed. The connectors can then be re-used.

* For 35 and 45 series products to be compliant with IAPMO ASSE 1061-2006: If PEX tubing is used, then a tube support liner must be used also. The tube support liner acts as an internal support for the end of the tube.

Sea Tech fittings are designed for low pressure fluids. For other applications please refer to our Customer Service Department. Tubing should be supported at a minimum of 36" to prevent excessive load to the connectors. Do not install tubing supports closer than 3 inches from the connector ends. We strongly recommend that new installations be thoroughly tested prior to use. Do not use with explosive gases, petroleum products or other fuels.

CAUTION

The polysulfone and polypropylene material in this SEA TECH product can be compromised by exposure to volatile organic compounds (VOCs) and caustic chemicals. Therefore, DO NOT expose this product to any such chemical or foreign substance, which would include exposure to the following products:

Pipe dopes (liquid thread sealants), leak check compounds, bug sprays, lubricants, cleaners, paints, bleaches, acids, solder fluxes, plastic piping primers and cements, oxidizing agents, alkaline solutions, thinners, fuels, oil based caulk, hydrocarbons, spray foam or foaming agents (i.e. insulation).

Teflon tape is acceptable and can be used for threaded connections.

Failure to follow these instructions will void the warranty and possibly result in leaks and water damage.



IAPMO Certified Fittings

IAPMO ASSE 1061-2006

Sea Tech 35 and 45 Series fittings are tested, certified, and approved to IAPMO ASSE 1061-2006 performance standards.

LEAD FREE

*The wetted surface of this product contacted by consumable water contains less than 0.25% of lead by weight.



SeaTech Pipe

Seapex Flex Pipe is made from high performance, cross linked polyethylene material. Is N.S.F. and F.D.A. recognized and is available in Red, Blue or White for ease of identification.



- Operating pressure: Vacuum to 160 P.S.I.
- Temp Range: Max 100 PSI @ 180°F Max 160 PSI @ 73°F
- Min Burst Pressure: 215 PSI @ 180°F 480 PSI @ 73°F

SPS 15MM-BLUE	15 mm	per foot	Blue
SPS 15MM-RED	15mm	per foot	Red
SPS 15MM-WHITE	15mm	per foot	White
SPS 2210R**	22mm	10' straight tube	Red
SPS 22MM-RED**	22mm	per foot	Red
SPS 22MM-WHITE**	22mm	per foot	White
SPS 28MM-BLUE**	28mm	per foot	Blue
SPS 1/2"WHITE	1/2" CTS	per foot	White

**** Limited Quantity**

SeaTech Poly Ice Maker Tube

- Made from low density Polyethylene
- 1/4" outside diameter
- F.D.A. approved for food contact
- Impermeable to gasses and moisture with a water absorption rate of 0.15% as per ASTM standards
- Light weight and flexible
- Operating pressure: Vacuum to 100 PSI
- Temp Range: -40°F to 150°F
- 100' coil sold by the foot



SPS 50256-FT

SeaTech SeaPex & Poly Tube Cutter

- Makes cutting of hose easy and convenient

SPS 1158-1522

Cutter

SPS 1161-1522

Replacement blade



SeaTech Bend Mounts

SPS 2349-15 90° - 15 mm

SPS 2349-22** 90° - 22 mm

SPS 2349-28** 90° - 28 mm

**** Limited Quantity**



SeaTech Male Collet Covers

- Made from Delrin
- Used to colour code lines



Part #	SeaPex Size	Colour
SPS 2156-15	15 mm	Blue
SPS 2154-15	15 mm	Red
SPS 2954-22**	22 mm	Red

**** Limited Quantity**

SeaTech Pipe Mounting Clips

- Clips can interlock to hold multiple pipes

SPS 2370-1557 15 mm

SPS 2370-2257 22 mm

SPS 2370-2857** 28 mm

**** Limited Quantity**



SeaTech Collet Clips

- Delrin
- Inserted onto collet for added security

SPS 1147-15 15 mm, each

SPS 01-1147-15 15 mm, 3/pkg

SPS 01-3547-10 1/2", 3/pkg



SeaTech Metric Series Pipe Fittings

Sea Tech connectors utilize a swivel nut with NPS straight threads and a cone seal. This allows the installer to thread onto NPT, NPS, BSP and most other threads without tools or thread sealant. Simply thread on, hand tight, for a zero-leak seal.

Manufactured in several high performance materials that are FDA and NSF-61 certified for drinking water.

- Operating Pressure: Vacuum 250psi
- Rated 140° F @ 100 psi / 75° F @ 250 psi

▪ Threaded female swivel connectors

SPS 01-1110-0815 15 mm x 1/2" NPS
SPS 01-1110-1215 15 mm x 3/4" NPS



▪ Union reducer

SPS 01-1116-1015 15 mm x 1/2" CTS



▪ Union connectors

SPS 01-1115-1515 15 mm x 15 mm
SPS 01-1615-2222 22 mm x 22 mm
SPS 01-2115-28** 28 mm x 28 mm
**** Limited Quantity**



▪ Union elbow connectors

SPS 01-1117-1515 15 mm x 15 mm
SPS 01-1617-2222 22 mm x 22 mm
SPS 01-2117-28** 28 mm x 28 mm
**** Limited Quantity**



▪ Stem elbow connectors

SPS 01-1118-1515 15 mm
SPS 01-1618-2222 22 mm



▪ Male elbow

SPS 01-1119-0815 15 mm x 1/2" NPT



▪ Female swivel elbow

SPS 01-1120-0815 15 mm x 1/2" NPS
SPS 01-1120-1215 15 mm x 3/4" NPS



▪ Union 'T' connectors

SPS 01-1123-1515 15 mm
SPS 01-1623-2222 22 mm
SPS 01-2123-28** 28 mm
SPS 1023-04 1/4" (bulk)
**** Limited Quantity**



▪ Female swivel tee

SPS 01-1125-0815 15 mm x 1/2" NPS



▪ Stackable T's

SPS 01-1133-1515 15 mm
SPS 1133-2222** 22 mm
**** Limited Quantity**



▪ End stop

SPS 01-1145-15 15 mm



▪ Reducing connectors

SPS 01-2114-2228** 28 mm stem x 22 mm
**** Limited Quantity**



▪ Reducing T connectors

Part #	A	B	C
SPS 01-1624-221515**	22 mm	15 mm	15 mm
SPS 01-1624-151522**	15 mm	15 mm	22 mm

**** Limited Quantity**



▪ Threaded male connector

SPS 01-2402-0815 15 mm x 1/2" NPT
SPS 01-2902-1222 22 mm x 3/4" NPT



▪ Hose barb connectors

SPS 01-2413-0815 1/2" barb x 15 mm
SPS 01-2913-1222 3/4" barb x 22 mm



SeaTech Pump Connectors

- Thermal plastic
- Fits Jabsco & Flojet pumps

SPS 01-2475-15 Union 15 mm
SPS 01-2476-15 Elbow 15 mm



SeaTech Brass Female Thread Stems

- Allows the connection to rotate under pressure

SPS 1726-1222** 22 mm x 3/4" NPT

SPS 2226-1628** 28 mm x 1" NPT

**** Limited Quantity**

**SeaTech Brass Male Thread Stems**

- Allows the connection to rotate under pressure

SPS 1229-0815 15 mm x 1/2" NPT

SPS 2229-1628** 28 mm x 1" NPT

**** Limited Quantity**

**SeaTech Brass Union Stem**

SPS 1732-2222** 22 mm

**** Limited Quantity**

**SeaTech Brass Male FPT-BSP Adapter**

SPS 17109-1212** 3/4" FPT x 3/4" BSP

**** Limited Quantity**

**SeaTech Manifold End Plug**

- Thermal plastic

SPS 1146-15 15 mm

**SeaTech Manifold Inlet Cap**

- Thermal plastic and brass

SPS 2274-16**

**SeaTech Brass Manifold Inlet Stem**

SPS 2262-22** 22 mm

**** Limited Quantity**

**Fairview PEX Coupling**

- Meets NSF 14/61, ASTM F1807, CSA B137.5 and UP CODE

FRV PEX129-14 3/4" - 3/4"

**SeaTech 1/2" Series Pipe Fittings**

Manufactured in several high performance materials that are FDA and NSF-61 certified for drinking water.

- Rated 140° F @ 100 psi / 75° F @ 250 psi

- Union connector

SPS 01-2415-10 1/2" CTS



- Union elbow

SPS 01-2417-10 1/2" CTS



- Stackable elbow

SPS 01-2418-10 1/2" CTS



- Union tee

SPS 01-2423-10 1/2" CTS



- Stackable tee

SPS 01-2433-10 1/2" CTS



- 24 Series end stop

SPS 01-2445-10 1/2" CTS



- Male connector

- Swivel nut has a NPS straight thread and a cone seal allowing the use of NPT, NPS, BSP and most other threads.

SPS 01-2401-1008 1/2" CTS x 1/2" NPT



- Collet clip

SPS 01-3547-10 1/2" CTS, 3/pk

**Size and Abbreviation Cross Reference**

3/8" CTS	1/2" OD
1/2" CTS	5/8" OD
3/4" CTS	7/8" OD
1" CTS	9/8" OD
NPT	National Pipe Thread Tapered
BSP	British Straight Pipe Thread
FGHT	Female Garden Hose Thread
MGHT	Male Garden Hose Thread
NPS	National Pipe Thread Straight
Closet	Toilet Connection
CTS	Copper Tube Size

SeaTech Union Pump Fitting

- Fits Jabsco & Flojet

SPS 01-3575-10 1/2" CTS

**SeaTech Reducing Union**

SPS 01-3516-1410** 3/4" x 1/2" CTS

**** Limited Quantity**

**SeaTech Shut Off Valve**

- Thermal plastic and brass construction

SPS 01-2939-2222 22 mm x 22 mm

**SeaTech Shut Off Valves**

- Thermal plastic, brass
- Good for hot or cold water
- Used for flow controls

SPS 01-2439-1515 15 mm x 15 mm

SPS 01-2440-1515 15 mm x 15 mm stem

**SeaTech Ice Maker T-Shut Off Valve**

- Thermal plastic

SPS 2444-0415 1/4" OD tube x 15 mm

**SeaTech Ice Maker Stem Shut Off Valve**

- Thermal plastic
- Complies with FDA and NSF standards

SPS 01-2443-0415 1/4" OD tube x 15 mm

**SeaTech Reducing Shut Off Valve**

- Thermal plastic

SPS 01-2439-0415 15 mm 1/4" OD

**SeaTech Shut Off Valve**

- Stop valve

SPS 01-3539-10 1/2" CTS

**SeaTech Speed-Tap**

- Washdown fitting incorporates an automatic shut-off valve
- Flush mounted with protective cover
- 1.2" NPT connection

SPS ST300

**SeaTech Speed-Tap Hose Adapter**

- Adapter threads into any standard garden hose to interconnect with the Speed-Tap
- Auto shut-off

SPS MSP100

**Plumbing Pipe Fittings****90° Elbow F.I.P. X F.I.P.**

Brass	Stainless
PLU BE 1/8"X90	PLU SE 1/8"X90
PLU BE 1/4"X90	PLU SE 1/4"X90
PLU BE 3/8"X90	PLU SE 3/8"X90
PLU BE 1/2"X90	PLU SE 1/2"X90
PLU BE 3/4"X90	PLU SE 3/4"X90
PLU BE 1"X90	PLU SE 1"X90
PLU BE 1-1/4"X90	PLU SE 1-1/4"X90
PLU BE 1-1/2"X90	PLU SE 1-1/2"X90
PLU BE 2"X90	PLU SE 2"X90
PLU BE 2-1/2"X90	-
PLU BE 3"X90	-

**Plumbing Pipe Fittings****45° Elbow F.I.P. X F.I.P.**

Brass	Stainless
-	PLU SE 1/8"X45
PLU BE 1/4"X45	PLU SE 1/4"X45
PLU BE 3/8"X45	PLU SE 3/8"X45
PLU BE 1/2"X45	PLU SE 1/2"X45
PLU BE 3/4"X45	PLU SE 3/4"X45
PLU BE 1"X45	PLU SE 1"X45
PLU BE 1-1/4"X45	PLU SE 1-1/4"X45
PLU BE 1-1/2"X45	PLU SE 1-1/2"X45
PLU BE 2"X45	PLU SE 2"X45
PLU BE 2-1/2"X45	-
PLU BE 3"X45	-



Plumbing Pipe Fittings 90° Street Elbow F.I.P. x M.I.P.

Brass	Stainless
-	PLU SS 1/8"X90
PLU BS 1/4"X90	PLU SS 1/4"X90
PLU BS 3/8"X90	PLU SS 3/8"X90
PLU BS 1/2"X90	PLU SS 1/2"X90
PLU BS 3/4"X90	PLU SS 3/4"X90
PLU BS 1"X90	PLU SS 1"X90
PLU BS 1-1/4"X90	PLU SS 1-1/4"X90
PLU BS 1-1/2"X90	PLU SS 1-1/2"X90
PLU BS 2"X90	PLU SS 2"X90
PLU BS 3"X90	-



Plumbing Pipe Fittings 45° Street Elbow F.I.P. x M.I.P.

Brass
PLU BS 1/2"X45
PLU BS 3/4"X45
PLU BS 1"X45
PLU BS 1-1/4"X45
PLU BS 1-1/2"X45



Plumbing Pipe Fittings Couplings - F.I.P. x F.I.P.

Brass	Stainless
-	PLU SCO 1/8"
-	PLU SCO 1/4"
PLU BCO 3/8"	PLU SCO 3/8"
PLU BCO 1/2"	PLU SCO 1/2"
PLU BCO 3/4"	PLU SCO 3/4"
PLU BCO 1"	PLU SCO 1"
PLU BCO 1-1/4"	PLU SCO 1-1/4"
PLU BCO 1-1/2"	PLU SCO 1-1/2"
PLU BCO 2"	PLU SCO 2"
PLU BCO 2-1/2"	-



Plumbing Pipe Fittings Reducing Coupling F.I.P. x F.I.P.

Brass	Stainless
PLU BRC 3/8" X1/4"	-
PLU BRC 1/2"X1/4"	PLU SRC 1/2"X1/4"
PLU BRC 1/2"X3/8"	PLU SRC 1/2"X3/8"
PLU BRC 3/4"X3/8"	PLU SRC 3/4"X3/8"
PLU BRC 3/4"X1/2"	PLU SRC 3/4"X1/2"
PLU BRC 1"X1/2"	PLU SRC 1"X1/2"
PLU BRC 1"X3/4"	PLU SRC 1"X3/4"
PLU BRC 1-1/4"X3/4"	PLU SRC 1-1/4"X3/4"
PLU BRC 1-1/4"X1"	PLU SRC 1-1/4"X1"
PLU BRC 1-1/2"X1/2"	-
PLU BRC 1-1/2"X3/4"	PLU SRC 1-1/2"X3/4"
PLU BRC 1-1/2"X1"	PLU SRC 1-1/2"X1"
PLU BRC 1-1/2"X1-1/4"	PLU SRC 1-1/2"X1-1/4"
-	PLU SRC 2"X1"
PLU BRC 2"X1-1/4"	PLU SRC 2"X1-1/4"
PLU BRC 2"X1-1/2"	PLU SRC 2"X1-1/2"
PLU BRC 2-1/2"X2"	-



Plumbing Pipe Fittings Tees - F.I.P. x F.I.P. x F.I.P.

Brass	Stainless
-	PLU ST 1/8"
PLU BT 1/4"	PLU ST 1/4"
PLU BT 3/8"	PLU ST 3/8"
PLU BT 1/2"	PLU ST 1/2"
PLU BT 3/4"	PLU ST 3/4"
PLU BT 1"	PLU ST 1"
PLU BT 1-1/4"	PLU ST 1-1/4"
PLU BT 1-1/2"	PLU ST 1-1/2"
PLU BT 2"	PLU ST 2"
PLU BT 2-1/2"	-



Plumbing Pipe Fittings Crosses - 4 x F.I.P.

Brass	Stainless
-	PLU SCR 1/4"
-	PLU SCR 3/8"
PLU BCR 1/2"	PLU SCR 1/2"
PLU BCR 3/4"	PLU SCR 3/4"
-	PLU SCR 1"
PLU BCR 1-1/4"	-
PLU BCR 1-1/2"	-



Plumbing Pipe Fittings

Nipples - M.I.P. x M.I.P.

Brass	Stainless
PLU BN 1/8"XCL	PLU SN 1/8"XCL
PLU BN 1/8"X1-1/2"	PLU SN 1/8"X1-1/2"
PLU BN 1/8"X2"	PLU SN 1/8"X2"
PLU BN 1/8"X2-1/2"	-
PLU BN 1/8"X3"	PLU SN 1/8"X3"
PLU BN 1/8"X3-1/2"	-
PLU BN 1/8"X4"	-
PLU BN 1/8"X4-1/2"	-
PLU BN 1/8"X5"	-
PLU BN 1/8"X5-1/2"	-
PLU BN 1/8"X6"	-
PLU BN 1/4"XCL	PLU SN 1/4"XCL
PLU BN 1/4"X1-1/2"	-
PLU BN 1/4"X2"	PLU SN 1/4"X2"
PLU BN 1/4"X2-1/2"	-
PLU BN 1/4"X3"	PLU SN 1/4"X3"
PLU BN 1/4"X3-1/2"	-
PLU BN 1/4"X4"	PLU SN 1/4"X4"
PLU BN 1/4"X4-1/2"	-
PLU BN 1/4"X5-1/2"	-
PLU BN 1/4"X6"	-
PLU BN 3/8"XCL	PLU SN 3/8"XCL
PLU BN 3/8"X1-1/2"	PLU SN 3/8"X1-1/2"
PLU BN 3/8"X2"	PLU SN 3/8"X2"
PLU BN 3/8"X2-1/2"	-
PLU BN 3/8"X3"	PLU SN 3/8"X3"
PLU BN 3/8"X3-1/2"	-
PLU BN 3/8"X4"	PLU SN 3/8"X4"
-	PLU SN 3/8"X5"
PLU BN 3/8"X5-1/2"	-
PLU BN 3/8"X6"	PLU SN 3/8"X6"
PLU BN 1/2"XCL	PLU SN 1/2"XCL
PLU BN 1/2"X1-1/2"	PLU SN 1/2"X1-1/2"
PLU BN 1/2"X2"	PLU SN 1/2"X2"
PLU BN 1/2"X2-1/2"	PLU SN 1/2"X2-1/2"
PLU BN 1/2"X3"	PLU SN 1/2"X3"
PLU BN 1/2"X3-1/2"	PLU SN 1/2"X3-1/2"
PLU BN 1/2"X4"	PLU SN 1/2"X4"
PLU BN 1/2"X4-1/2"	-
PLU BN 1/2"X5"	PLU SN 1/2"X5"
PLU BN 1/2"X5-1/2"	-
PLU BN 1/2"X6"	PLU SN 1/2"X6"
PLU BN 3/4"XCL	PLU SN 3/4"XCL
PLU BN 3/4"X2"	PLU SN 3/4"X2"
PLU BN 3/4"X2-1/2"	PLU SN 3/4"X2-1/2"
PLU BN 3/4"X3"	PLU SN 3/4"X3"
-	PLU SN 3/4"X3-1/2"
PLU BN 3/4"X4"	PLU SN 3/4"X4"
PLU BN 3/4"X4-1/2"	-
-	PLU SN 3/4"X5"



Brass	Stainless
PLU BN 3/4"X5-1/2"	-
PLU BN 3/4"X6"	PLU SN 3/4"X6"
PLU BN 1"XCL	PLU SN 1"XCL
PLU BN 1"X2"	PLU SN 1"X2"
PLU BN 1"X2-1/2"	PLU SN 1"X2-1/2"
PLU BN 1"X3"	PLU SN 1"X3"
PLU BN 1"X3-1/2"	PLU SN 1"X3-1/2"
PLU BN 1"X4"	PLU SN 1"X4"
PLU BN 1"X5"	PLU SN 1"X5"
PLU BN 1"X5-1/2"	-
PLU BN 1"X6"	PLU SN 1"X6"
-	PLU SN 1"X8"
PLU BN 1-1/4"XCL	PLU SN 1-1/4"XCL
PLU BN 1-1/4"X2"	-
PLU BN 1-1/4"X2-1/2"	PLU SN 1-1/4"X2-1/2"
PLU BN 1-1/4"X3"	PLU SN 1-1/4"X3"
PLU BN 1-1/4"X3-1/2"	-
PLU BN 1-1/4"X4"	PLU SN 1-1/4"X4"
PLU BN 1-1/4"X4-1/2"	-
PLU BN 1-1/4"X5"	PLU SN 1-1/4"X5"
PLU BN 1-1/4"X5-1/2"	-
PLU BN 1-1/4"X6"	PLU SN 1-1/4"X6"
PLU BN 1-1/2"XCL	PLU SN 1-1/2"XCL
PLU BN 1-1/2"X2"	-
PLU BN 1-1/2"X2-1/2"	PLU SN 1-1/2"X2-1/2"
PLU BN 1-1/2"X3"	PLU SN 1-1/2"X3"
-	PLU SN 1-1/2"X3-1/2"
PLU BN 1-1/2"X4"	PLU SN 1-1/2"X4"
PLU BN 1-1/2"X4-1/2"	-
PLU BN 1-1/2"X5"	PLU SN 1-1/2"X5"
PLU BN 1-1/2"X5-1/2"	-
PLU BN 1-1/2"X6"	PLU SN 1-1/2"X6"
PLU BN 2"XCL	PLU SN 2"XCL
PLU BN 2"X2-1/2"	PLU SN 2"X2-1/2"
PLU BN 2"X3"	PLU SN 2"X3"
PLU BN 2"X3-1/2"	PLU SN 2"X3-1/2"
PLU BN 2"X4"	PLU SN 2"X4"
PLU BN 2"X5"	PLU SN 2"X5"
PLU BN 2"X6"	PLU SN 2"X6"
PLU BN 2-1/2"XCL	-
PLU BN 2-1/2"X3"	-
PLU BN 3"XCL	-

Plumbing Pipe Fittings Caps - F.I.P.

Brass	Stainless
-	PLU SCA 1/8"
PLU BCA 1/4"	PLU SCA 1/4"
PLU BCA 3/8"	PLU SCA 3/8"
PLU BCA 1/2"	PLU SCA 1/2"
PLU BCA 3/4"	PLU SCA 3/4"
PLU BCA 1"	PLU SCA 1"
PLU BCA 1-1/4"	PLU SCA 1-1/4"
PLU BCA 1-1/2"	PLU SCA 1-1/2"
PLU BCA 2"	PLU SCA 2"



Plumbing Pipe Fittings Hex Bushings M.I.P x F.I.P.

Brass	Stainless
-	PLU SB 1/4"X1/8"
-	PLU SB 3/8"X1/4"
-	PLU SB 1/2"X1/4"
PLU BB 1/2"X3/8"	PLU SB 1/2"X3/8"
PLU BB 3/4"X1/8"	-
PLU BB 3/4"X1/4"	-
PLU BB 3/4"X3/8"	PLU SB 3/4"X3/8"
PLU BB 3/4"X1/2"	PLU SB 3/4"X1/2"
PLU BB 1"X1/4"	-
PLU BB 1"X3/8"	-
PLU BB 1"X1/2"	PLU SB 1"X1/2"
PLU BB 1"X3/4"	PLU SB 1"X3/4"
PLU BB 1-1/4"X1/2"	-
PLU BB 1-1/4"X3/4"	PLU SB 1-1/4"X3/4"
PLU BB 1-1/4"X1"	PLU SB 1-1/4"X1"
PLU BB 1-1/2"X1/4"***	-
PLU BB 1-1/2"X1/2"	-
PLU BB 1-1/2"X3/4"	PLU SB 1-1/2"X3/4"
PLU BB 1-1/2"X1"	PLU SB 1-1/2"X1"
PLU BB 1-1/2"X1-1/4"	PLU SB 1-1/2"X1-1/4"
PLU BB 2"X3/4"	-
PLU BB 2"X1"	PLU SB 2"X1"
PLU BB 2"X1-1/4"	PLU SB 2"X1-1/4"
PLU BB 2"X1-1/2"	PLU SB 2"X1-1/2"
PLU BB 2-1/2"X2"	-



** Limited Quantity

Plumbing Pipe Fittings Plugs, Cored - M.I.P.

Brass	Stainless
-	PLU SP 1/8"
-	PLU SP 1/4"
-	PLU SP 3/8"
-	PLU SP 1/2"
PLU BP 3/4"	PLU SP 3/4"
PLU BP 1"	PLU SP 1"
PLU BP 1-1/4"	PLU SP 1-1/4"
PLU BP 1-1/2"	PLU SP 1-1/2"
PLU BP 2"	PLU SP 2"



Plumbing Pipe Fittings Plugs, Cored - M.I.P. Countersunk Head

Stainless
PLU SCP 1/4"
PLU SCP 3/8"
PLU SCP 1/2"
PLU SCP 3/4"
PLU SCP 1"



Plumbing Pipe Fittings Floor Flanges

• (ASME drilling to ASA B16-24)

Brass
PLU BF 1/2"
PLU BF 3/4"
PLU BF 1-1/4"***
PLU BF 1-1/2"

** Limited Quantity



Plumbing Pipe Fittings Unions - F.I.P. x F.I.P.

Brass	Stainless
PLU BU 1/2"	PLU SU 1/2"
PLU BU 3/4"	PLU SU 3/4"
PLU BU 1"	PLU SU 1"



Plumbing All Round Strapping

PLU 1/2" COPPER	25 foot roll
PLU 3/4" COPPER	25 foot roll

**Refrigeration Copper Tubing (ASTM B280)**

▪ Size: O.D., inch x roll length (feet)

Part #	Wall Thickness	W.P. P.S.I.
COP CT1/8-50	.030	2400
COP CT3/16-50	.030	1200
COP CT1/4-50	.030	1200
COP CT5/16-50	.032	1020
COP CT3/8-50	.032	850
COP CT5/8-50	.035	560
COP CT3/4-50	.035	470

**General Purpose Copper Tubing (ASTM B75)**

▪ Size: O.D., inch x roll length (feet)

Part #	Wall Thickness	W.P. P.S.I.
COP CT1/4-25	.030	1200
COP CT5/16-25	.032	1020
COP CT1/2-25	.032	640

**Fairview Fittings - Brass Pipe Fittings****FPT Couplings**

Part #	Size
FRV 103-A	1/8"
FRV 103-B	1/4"
FRV 103-C	3/8"
FRV 103-D	1/2"

**Bushings - Male to Female**

Part #	Size
FRV 110-BA	1/4" x 1/8"
FRV 110-CA	3/8" x 1/8"
FRV 110-CB	3/8" x 1/4"
FRV 110-DA	1/2" x 1/8"
FRV 110-DB	1/2" x 1/4"
FRV 110-DC	1/2" x 3/8"

**Locknut**

Part #	Size
FRV 111-C	3/8"

**Fairview Fittings - Brass Pipe Fittings****Adapters - Female to Male**

Part #	Size
FRV 120-AA	1/8" x 1/8"
FRV 120-BA	1/4" x 1/8"
FRV 120-CB	3/8" x 1/4"
FRV 120-DB	1/2" x 1/4"
FRV 120-DC	1/2" x 3/8"
FRV 120-DD	1/2" x 1/2"

**Reducing Couplings**

Part #	Size
FRV 119-BA	1/4" x 1/8"
FRV 119-CA	3/8" x 1/8"
FRV 119-CB	3/8" x 1/4"
FRV 119-DC	1/2" x 3/8"

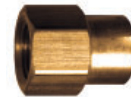
**Plugs - Square Head**

Part #	Size
FRV 109-A	1/8"
FRV 109-B	1/4"
FRV 109-C	3/8"
FRV 109-D	1/2"

**Plugs - Hex Head Countersunk**

Part #	Size
FRV 118-D	1/2"

**Plugs - Hex Head**

Part #	Size	Type
FRV 121-A	1/8"	Cored
FRV 121-B	1/4"	Cored
FRV 121S-B	1/4"	Solid
FRV 121-C	3/8"	Cored
FRV 121-D	1/2"	Cored
FRV 121S-E	3/4"	Solid

**Caps**

Part #	Size
FRV 108-A	1/8"
FRV 108-B	1/4"
FRV 108-C	3/8"



Fairview Fittings - Brass Pipe Fittings**Hex Nipple**

Part #	Size
FRV 122-A	1/8"
FRV 122-B	1/4"
FRV 122-BA	1/4" x 1/8"
FRV 122-C	3/8"
FRV 122-CA	3/8" x 1/8"
FRV 122-CB	3/8" x 1/4"
FRV 122-D	1/2"
FRV 122-DC	1/2" x 3/8"
FRV 122-E	3/4"

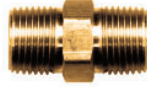
**90° Elbow**

Part #	Size	Style
FRV X100-A	1/8"	Extruded
FRV 100-A	1/8"	Forged
FRV X100-B	1/4"	Extruded
FRV 100-B	1/4"	Forged
FRV 100-C	3/8"	Forged
FRV 100-D	1/2"	Forged
FRV 100-E	3/4"	Forged

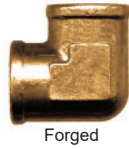
**45° Street Elbow**

Part #	Size	Style
FRV 124-A	1/8"	Forged
FRV X124-A	1/8"	Extruded
FRV 124-B	1/4"	Forged
FRV X124-B	1/4"	Extruded
FRV 124-C	3/8"	Forged
FRV X124-C	3/8"	Extruded

**Forged 90° Street Elbow**

Part #	Size
FRV 116-A	1/8"
FRV 116-B	1/4"
FRV 116-C	3/8"
FRV 116-D	1/2"
FRV 116-E	3/4"

**Extruded 90° Street Elbow**

Part #	Size
FRV X115-A	1/8"
FRV X115-B	1/4"
FRV X115-C	3/8"
FRV X115-D	1/2"

**Fairview Fittings - Brass Pipe Fittings****Forged Elbow 90°**

Part #	Size
FRV 99-B	1/4"

**Male Branch Tee**

Part #	Size	Style
FRV 106-B	1/4"	Forged
FRV X106-B	1/4"	Extruded
FRV X106-C	3/8"	Extruded



Forged



Extruded

Tees

Part #	Size	Style
FRV 101-A	1/8"	Forged
FRV X101-A	1/8"	Extruded
FRV 101-B	1/4"	Forged
FRV X101-B	1/4"	Extruded
FRV 101-C	3/8"	Forged
FRV X101-C	3/8"	Extruded
FRV 101-D	1/2"	Forged



Forged



Extruded

Street Tee

Part #	Size	Style
FRV 107-B	1/4"	Forged
FRV X107-B	1/4"	Extruded
FRV 107-C	3/8"	Forged
FRV 107-D	1/2"	Forged



Forged

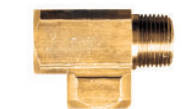

Extruded

Forged Cross

Part #	Size
FRV 102-A	1/8"
FRV 102-C	3/8"



Fairview Fittings - Brass 45° Flare**Forged Nut - Short Type**

Part #	Length	Tube
FRV 40-6	13/16"	3/8"
FRV FO41S-10	1-1/8"	5/8"

**Milled Nut - Short Type**

Part #	Length	Tube
FRV 41S-3	5/8"	3/16"
FRV 41S-4	3/4"	1/4"
FRV 41S-5	7/8"	5/16"
FRV 41S-6	7/8"	3/8"
FRV 41S-8	1"	1/2"

**Milled Nut - Long Type**

Part #	Length	Tube
FRV 41-4	15/16"	1/4"
FRV 41-5	1-1/8"	5/16"
FRV 41-6	1-5/16"	3/8"
FRV 41-8	1-5/8"	1/2"
FRV 41-10	1-7/8"	5/8"

**Tube Coupling - Female Flare to Female Flare**

Part #	Tube	Tube
FRV 32-6	3/8"	3/8"

**Tube Coupling - Female Swivel Flare to Female Swivel Flare**

Part #	Tube	Tube
FRV 34-4	1/4"	1/4"
FRV 34-5	5/16"	5/16"
FRV 34-6	3/8"	3/8"
FRV 34-8	1/2"	1/2"
FRV 34-10	5/8"	5/8"
FRV 34-12	3/4"	3/4"

**Union Coupling - Tube to Tube**

Part #	Tube	Tube
FRV 42-2	1/8"	1/8"
FRV 42-3	3/16"	3/16"
FRV 42-4	1/4"	1/4"
FRV 42-5	5/16"	5/16"
FRV 42R-64	3/8"	1/4"
FRV 42R-65	3/8"	5/16"
FRV 42-6	3/8"	3/8"
FRV 42R-86	1/2"	3/8"
FRV 42-8	1/2"	1/2"
FRV 42-10	5/8"	5/8"

**Fairview Fittings - Brass 45° Flare****Connector - Tube to Female Pipe**

Part #	Tube	Pipe
FRV 46-4A	1/4"	1/8"
FRV 46-4B	1/4"	1/4"
FRV 46-4C	1/4"	3/8"
FRV 46-4D	1/4"	1/2"
FRV 46-6A	3/8"	1/8"
FRV 46-6B	3/8"	1/4"
FRV 46-6C	3/8"	3/8"
FRV 46-6D	3/8"	1/2"
FRV 46-8C	1/2"	3/8"
FRV 46-8D	1/2"	1/2"
FRV 46-10D	5/8"	1/2"

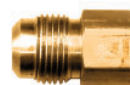
**Connector - Tube to Male Pipe**

Part #	Tube	Pipe
FRV 48-3A	3/16"	1/8"
FRV 48-4A	1/4"	1/8"
FRV 48-4B	1/4"	1/4"
FRV 48-4C	1/4"	3/8"
FRV 48-5A	5/16"	1/8"
FRV 48-5B	5/16"	1/4"
FRV 48-5C	5/16"	3/8"
FRV 48-6A	3/8"	1/8"
FRV 48-6B	3/8"	1/4"
FRV 48-6C	3/8"	3/8"
FRV 48-6D	3/8"	1/2"
FRV 48-8B	1/2"	1/4"
FRV 48-8C	1/2"	3/8"
FRV 48-8D	1/2"	1/2"
FRV 48-8E	1/2"	3/4"
FRV 48-10C	5/8"	3/8"
FRV 48-10D	5/8"	1/2"
FRV 48-10E	5/8"	3/4"

**90° Elbow - Tube to Female Pipe**

Part #	Tube	Pipe
FRV 50-6A	3/8"	1/8"
FRV 50-6B	3/8"	1/4"
FRV 50-6C	3/8"	3/8"
FRV 50-6D	3/8"	1/2"
FRV 50-8C	1/2"	3/8"
FRV 50-8D	1/2"	1/2"
FRV 50-10D	5/8"	1/2"



Fairview Fittings - Brass 45° Flare**90° Elbow - Tube to Male Pipe**

Part #	Tube	Pipe
FRV 49-4A	1/4"	1/8"
FRV 49-4B	1/4"	1/4"
FRV 49-4C	1/4"	3/8"
FRV 49-5A	5/16"	1/8"
FRV 49-5B	5/16"	1/4"
FRV 49-6A	3/8"	1/8"
FRV 49-6B	3/8"	1/4"
FRV 49-6C	3/8"	3/8"
FRV 49-6D	3/8"	1/2"
FRV 49-8B	1/2"	1/4"
FRV 49-8C	1/2"	3/8"
FRV 49-8D	1/2"	1/2"
FRV 49-8E	1/2"	3/4"
FRV 49-10C	5/8"	3/8"
FRV 49-10D	5/8"	1/2"
FRV 49-12D	3/4"	1/2"
FRV 49-12E	3/4"	3/4"

**45° Elbow - Tube to Male Pipe**

Part #	Tube	Pipe
FRV 54-4B	1/4"	1/4"
FRV 54-8C	1/2"	3/8"

**90° Elbow - Tube to Tube**

Part #	Tube
FRV 55-4	1/4"
FRV 55-5	5/16"
FRV 55-6	3/8"
FRV 55-8	1/2"
FRV 55-10	5/8"

**Tee - Tube Three Ends**

Part #	Tube
FRV 44-4	1/4"
FRV 44-5	5/16"
FRV 44-6	3/8"
FRV 44-8	1/2"
FRV 44-10	5/8"

**Tee - Tube Ends - Centre Pipe (Male)**

Part #	Tube	Tube	Pipe
FRV 45-4B	1/4"	1/4"	1/4"
FRV 45-6B	3/8"	3/8"	1/4"
FRV 45-8C	1/2"	1/2"	3/8"
FRV 45-8D	1/2"	1/2"	1/2"

**Fairview Fittings - Brass 45° Flare****Reducing Tees**

Part #	1	2	3
FRV 44R-86	1/2"	1/2"	3/8"
FRV 44R-106	5/8"	5/8"	3/8"
FRV 44R-108	5/8"	5/8"	1/2"
FRV 44R-866	1/2"	3/8"	3/8"

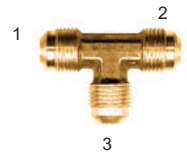
**Tee Ends - Pipe Centre (Female)**

Part #	Tube	Tube	Pipe
FRV 36-4B	1/4"	1/4"	1/4"
FRV 36-6B	3/8"	3/8"	1/4"

**Cross - Tube Four Ends**

Part #	Tube
FRV 52-6	3/8"
FRV 52-8	1/2"

**Tee Ends - One Tube and One Pipe Centre - Tube**

Part #	Pipe	Tube
FRV 51-6B	1/4"	3/8"
FRV 51-8C	3/8"	1/2"
FRV 51-8D	1/2"	1/2"

**Sealing Cap Nut**

Part #	Tube
FRV 56-4	1/4"
FRV 56-5	5/16"
FRV 56-6	3/8"
FRV 56-8	1/2"
FRV 56-10	5/8"

**Sealing Cap Plug**

Part #	Tube
FRV 58-4	1/4"
FRV 58-5	5/16"
FRV 58-6	3/8"
FRV 58-8	1/2"
FRV 58-10	5/8"

**Fairview Fittings - Brass 45° Inverted Flare****Connector Inverted Flare To Male Pipe**

Part #	Pipe	Tube
FRV 148-4B	1/4"	1/4"



Fairview Brass Compression Fittings**Standard Sleeve**

Part #	Tube
FRV 60-4	1/4"
FRV 60-5	5/16"
FRV 60-6	3/8"
FRV 60-8	1/2"
FRV 60-10	5/8"

**Brass Compression Fittings
Standard Nut**

Part #	Tube
FRV 61-4	1/4"
FRV 61-5	5/16"
FRV 61-6	3/8"

**Brass Compression Fittings
Union Coupling**

Part #	Tube
FRV 62-4	1/4"
FRV 62-5	5/16"
FRV 62-6	3/8"
FRV 62-8	1/2"
FRV 62-10	5/8"

**Brass Compression Fittings
Connector - Tube to Female Pipe**

Part #	Tube	Pipe
FRV 66-2A	1/8"	1/8"
FRV 66-5B	5/16"	1/4"
FRV 66-6B	3/8"	1/4"

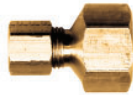
**Brass Compression Fittings
Connector - Tube to Male Pipe**

Part #	Tube	Pipe
FRV 68-2A	1/8"	1/8"
FRV 68-3B	3/16"	1/4"
FRV 68-4A	1/4"	1/8"
FRV 68-4B	1/4"	1/4"
FRV 68-6A	3/8"	1/8"
FRV 68-6B	3/8"	1/4"
FRV 68-6C	3/8"	3/8"
FRV 68-6D	3/8"	1/2"
FRV 68-8B	1/2"	1/4"
FRV 68-8D	1/2"	1/2"
FRV 68-10D	5/8"	1/2"

**Brass Compression Fittings
45° Male Pipe Elbow**

Part #	Tube O.D.	Pipe
FRV 74-6B	3/8"	1/4"

**Fairview Brass Compression Fittings****90° Elbow - Tube to Male Pipe**

Part #	Tube	Pipe
FRV 69-4A	1/4"	1/8"
FRV 69-4B	1/4"	1/4"
FRV 69-5B	5/16"	1/4"
FRV 69-6B	3/8"	1/4"
FRV 69-6C	3/8"	3/8"
FRV 69-8B	1/2"	1/4"

**Brass Compression Fittings
90° Elbow - Tube to Tube**

Part #	Tube	Tube
FRV 65-10	5/8"	5/8"

**Brass Compression Fittings
Tee - Tube Three Ends**

Part #	Tube
FRV 64-4	1/4"
FRV 64-5	5/16"
FRV 64-6	3/8"



Fairview Brass Hose Barb Fittings**Coupler - Hose Barb to Male**

Part #	Hose I.D.	Tube O.D.
FRV 127-66	3/8"	3/8"
FRV 127-88	1/2"	1/2"

**Swivel Coupler**

Part #	Hose I.D.	Tube O.D.
FRV 128-44	1/4"	1/4"
FRV 128-55	5/16"	5/16"
FRV 128-56	5/16"	3/8"
FRV 128-66	3/8"	3/8"
FRV 128-88	1/2"	1/2"

**Hose Barb Fittings Coupler
Hose Barb to Male Pipe**

Part #	Hose I.D.	Pipe
FRV 125-2B	1/8"	1/4"
FRV 125-3A	3/16"	1/8"
FRV 125-3B	3/16"	1/4"
FRV 125-4A	1/4"	1/8"
FRV 125-4B	1/4"	1/4"
FRV 125-4C	1/4"	3/8"
FRV 125-4D	1/4"	1/2"
FRV 125-5A	5/16"	1/8"
FRV 125-5B	5/16"	1/4"
FRV 125-5C	5/16"	3/8"
FRV 125-6A	3/8"	1/8"
FRV 125-6B	3/8"	1/4"
FRV 125-6C	3/8"	3/8"
FRV 125-6D	3/8"	1/2"
FRV 125-8B	1/2"	1/4"
FRV 125-8C	1/2"	3/8"
FRV 125-8D	1/2"	1/2"
FRV 125-8E	1/2"	3/4"
FRV 125-10C	5/8"	3/8"
FRV 125-10D	5/8"	1/2"
FRV 125-10E	5/8"	3/4"
FRV 125-12D	3/4"	1/2"
FRV 125-12E	3/4"	3/4"
FRV 125-16E	1"	3/4"
FRV 125-16H	1"	1"

**Fairview Brass Hose Barb Fittings****Hose Coupler Hose Barb to Female Pipe**

Part #	Hose I.D.	Pipe
FRV 126-2A	1/8"	1/8"
FRV 126-3B	3/16"	1/4"
FRV 126-4A	1/4"	1/8"
FRV 126-4B	1/4"	1/4"
FRV 126-4C	1/4"	3/8"
FRV 126-5A	5/16"	1/8"
FRV 126-5B	5/16"	1/4"
FRV 126-6A	3/8"	1/8"
FRV 126-6B	3/8"	1/4"
FRV 126-6C	3/8"	3/8"
FRV 126-6D	3/8"	1/2"
FRV 126-8B	1/2"	1/4"
FRV 126-8C	1/2"	3/8"
FRV 126-8D	1/2"	1/2"

**90° Elbow Hose Barb to Male Pipe**

Part #	Hose I.D.	Pipe
FRV 139-4A	1/4"	1/8"
FRV 139-4B	1/4"	1/4"
FRV 139-5A	5/16"	1/8"
FRV 139-5B	5/16"	1/4"
FRV 139-5C	5/16"	3/8"
FRV 139-6A	3/8"	1/8"
FRV 139-6B	3/8"	1/4"
FRV 139-6C	3/8"	3/8"
FRV 139-6D	3/8"	1/2"
FRV 139-8B	1/2"	1/4"
FRV 139-8C	1/2"	3/8"
FRV 139-8D	1/2"	1/2"
FRV 139-10C	5/8"	3/8"
FRV 139-10D	5/8"	1/2"
FRV 139-12D	3/4"	1/2"

**45° Elbow - Hose Barb to Male Pipe**

Part #	Hose I.D.	Pipe
FRV 140-4A	1/4"	1/8"
FRV 140-5A	5/16"	1/8"
FRV 140-6A	3/8"	1/8"
FRV 140-6B	3/8"	1/4"
FRV 140-6C	3/8"	3/8"



Fairview Grip-Tite Hose Fittings**Male Pipe- Grip Tite**

Part #	Hose I.D.	Pipe
FRV 725-4A	1/4"	1/8"
FRV 725-4B	1/4"	1/4"
FRV 725-4C	1/4"	3/8"
FRV 725-6A	3/8"	1/8"
FRV 725-6B	3/8"	1/4"
FRV 725-6C	3/8"	3/8"
FRV 725-6D	3/8"	1/2"
FRV 725-8B	1/2"	1/4"
FRV 725-8C	1/2"	3/8"
FRV 725-8D	1/2"	1/2"
FRV 725-10C	5/8"	3/8"
FRV 725-10D	5/8"	1/2"
FRV 725-12D	3/4"	1/2"
FRV 725-12E	3/4"	3/4"

**Grip-Tite Hose Fittings Hose Splicer**

Part #	Hose I.D.
FRV 729-4	1/4"
FRV 729-5	5/16"
FRV 729-6	3/8"
FRV 729-8	1/2"
FRV 729-10	5/8"
FRV 729-12	3/4"

**Grip-Tite Hose Fittings Rigid Female Pipe**

Part #	Hose I.D.	Pipe
FRV 726-4B	1/4"	1/4"
FRV 726-6B	3/8"	1/4"
FRV 726-6C	3/8"	3/8"

**Grip-Tite Fittings 45° SAE Female Flare Swivel**

Part #	Hose I.D.	Tube
FRV 728-44	1/4"	1/4"
FRV 728-45	1/4"	5/16"
FRV 728-66	3/8"	3/8"
FRV 728-68	3/8"	1/2"
FRV 728-86	1/2"	3/8"
FRV 728-88	1/2"	1/2"
FRV 728-810	1/2"	5/8"
FRV 728-108	5/8"	1/2"
FRV 728-1010	5/8"	5/8"

**Grip-Tite Fittings 45° SAE Male Inverted Flare Swivel**

Part #	Hose I.D.	Tube
FRV 735-44	1/4"	1/4"
FRV 735-45	1/4"	5/16"

**Fairview Grip-Tite Hose Fittings****Grip-Tite Fitting 37° J.I.C. Male Flare**

Part #	Hose I.D.	Tube
FRV 737-66	3/8"	3/8"

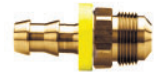
**Grip-Tite Fitting 45° SAE Male Flare**

Part #	Hose I.D.	Pipe
FRV 727-66	3/8"	3/8"

**Fairview Hose Barb Fittings****Splicer - hex shoulder**

Part #	Hose I.D.
FRV 129-4	1/4"
FRV 129-5	5/16"
FRV 129-6	3/8"
FRV 129-8	1/2"

**Fairview Hose Barb Fittings****Hose barb all ends - hex shoulder**

Part #	Hose I.D.
FRV 123-5	5/16"
FRV 123-6	3/8"

**Fairview Hose Poly Tube Fittings****Tee - tube three ends**

Part #	Tube O.D.	Tube I.D.
FRV 964-6	3/8"	1/4"
FRV 964-8	1/2"	3/8"

**Fairview Water Hose Fittings****• Coupling - male hose to male pipe**

Part #	Pipe
FRV 196-D	1/2"
FRV 196-E	3/4"

**Fairview Water Hose Fittings****• Coupling - male hose to female pipe**

Part #	Pipe
FRV 197-D	1/2"
FRV 197-E	3/4"

**Fairview Water Hose Fittings****• Coupling - female hose to female pipe**

Part #	Pipe
FRV 198-D	1/2"
FRV 198-E	3/4"



Fairview Water Hose Fittings

- Swivel coupling - female hose to female pipe

Part #	Pipe
FRV 199S-D	1/2"
FRV 199S-E	3/4"

**Fairview Water Hose Fitting**

- Coupling - female hose to female garden hose

FRV 203-W

**Fairview Water Hose Fittings**

- Connector - hose barb to male hose

Part #	Hose I.D.
FRV 193-6	3/8"
FRV 193-8	1/2"
FRV 193-10	5/8"
FRV 193-12	3/4"

**Fairview Water Hose Fittings**

- Connector - hose barb to female hose

Part #	Hose I.D.
FRV 195-8	1/2"
FRV 195-10	5/8"
FRV 195-12	3/4"

**Fairview Water Hose Fitting**

- Hex-knurl cap nut w/chain

FRV 200-HKC

**EVM Aluminum 90° Barbed Elbows**

- 6000 series aluminum

EVM BE-1438	1/4" NPT x 3/8" hose
EVM BE-3838	3/8" NPT x 3/8" hose
EVM BE-3858	3/8" NPT x 5/8" hose

**EVM Aluminum Bulkhead Fitting**

- 6000 series aluminum

EVM BH-3838 3/8" hose to hose

**EVM Aluminum Hose Barbs**

- 6000 series aluminum

EVM HB-1414	1/4" NPTF x 1/4" hose
EVM HB-1415	1/4" NPTF x 5/16" hose
EVM HB-1438	1/4" NPTF x 3/8" hose
EVM HBL-1212	1/2" NPTF x 1/2" hose
EVM HBL-1238	1/2" NPTF x 3/8" hose
EVM HBL-1258	1/2" NPTF x 5/8" hose
EVM HBL-1438	1/4" NPTF x 3/8" hose
EVM HBL-3838	3/8" NPTF x 3/8" hose
EVM HBL-3858	3/8" NPTF x 5/8" hose

**FYI****NPT vs NPTF Taper Pipe Threads**

NPT threads are for mechanical or low-pressure air or fluid applications and require the use of sealing compounds like Teflon tape, to provide the seal. When the application is more critical, and the sealing compound may fail due to high heat or pressure, NPTF Dryseal threads are used. This mechanical seal is produced by the mating and slight crushing of the threads when a wrench is applied to tighten the fittings.

Since NPT threaded parts require sealing compounds, it is acceptable to use an NPTF tap for NPT applications. However, NPT taps cannot be used for NPTF applications, as it will likely produce a thread that will leak.

EVM Aluminum Pipe Plugs

- 6000 series aluminum

EVM PP-1400	1/4" NPTF x 9/16" hex
EVM PP-3800	3/8" NPTF x 11/16" hex
EVM PP-1200	1/2" NPTF x 7/8" hex
EVM PP-3400	3/4" NPTF x 1-1/8" hex

EVM Steel Pipe Plug

EVM PP-3800-S** 3/8" NPTF x 11/16" hex

** Limited Quantity

**EVM Stainless Steel Pipe Plugs**

- Stainless steel

EVM PP-1400-SS	1/4" NPTF x 9/16" hex
EVM PP-3800-SS	3/8" NPTF x 11/16" hex

EVM Reducing Bushings

- 6000 series aluminum

EVM RB-3814	3/8" NPTF x 1/4"
EVM RB-1238	1/2" NPTF x 3/8"

**EVM 90° Street Elbows**

- 6000 series aluminum

EVM SE-3814	3/8" NPTF male x 1/4" female
EVM SE-1212	1/2" NPTF male x 1/2" female

**EVM Tank Welding Bosses**

- 6000 series aluminum

EVM TB-6838	3/8" NPTF x 1-1/8" dia.
EVM TB-6812	1/2" NPTF x 1-1/2" dia.
EVM TB-6834	3/4" NPTF x 1-1/2" dia.
EVM TB-6810	1" NPTF x 2" dia.

**EVM Valves**

- Fuel shut off valves
- Meet ABYC 2-1/2 min. fire test
- All aluminum construction

EVM SV-120-1438	1/4" NPTF x 3/8" hose barb
EVM SV-130-3838	3/8" NPTF x 3/8" hose barb

**EVM Marine Fittings and Hardware**

All EVM products are designed to conform to existing A.B.Y.C. and Coast Guard Standards and Regulations.

Groco E-Valve Seacocks

- Motorized valve operation for seacock sizes 3/4" to 3"
- Wireless control from helm; pushbutton control from engine room
- Touchpad control (shown) is standard. Optional LCD touchscreen provides wireless control from the helm
- LCD display operates all of your E-Valves and GROCO SSA flow monitor system
- Programmable set-up mode commands the generator seacock (or any other seacock) to open when you start and close when the generator stops. No more generator flooding
- Manual valve operation without backdriving the gear train and without disconnecting anything - just operate the valve as a standard manual seacock
- Minimal power draw
- Reversible gearbox mount enables selectable direction of handle rotation
- Same mount bolt pattern as GROCO FBV and BV, and most other brands
- Fully submersible
- UL listed bronze seacock
- NMEA2000 ready
- IP67 rated
- CP-712 compliant
- 24V models available

* Special Order Request Items

Part #	PIPE SIZE	A	B	C	D	E	F	WEIGHT
GRO FBVE-750 12V*	3/4"	6.1"	6.4"	4.5"	2.0"	3.12"	3" x 5/16"	4.4 lbs
GRO FBVE-1000 12V*	1"	7.3"	6.5"	4.8"	2.1"	3.38"	3" x 5/16"	5.0 lbs
GRO FBVE-1250 12V*	1-1/4"	7.1"	6.6"	5.0"	2.3"	3.62"	3" x 5/16"	5.8 lbs
GRO FBVE-1500 12V*	1-1/2"	9.5"	7.0"	5.2"	2.7"	4.50"	3" x 5/16"	7.1 lbs
GRO FBVE-2000 12V*	2"	10.1"	7.3"	5.5"	3.0"	5.00"	3" x 3/8"	9.7 lbs
GRO FBVE-2500 12V*	2-1/2"	12.4"	9.2"	6.7"	3.6"	5.88"	3" x 3/8"	22.0 lbs
GRO FBVE-3000 12V*	3"	14.8"	9.7"	6.7"	4.2"	7.00"	3" x 3/8"	31.0 lbs

* Request Item

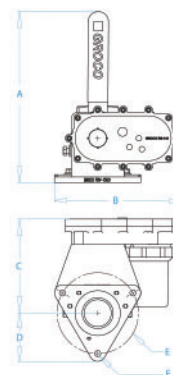

Marelon Flanged Seacocks

- Component style seacocks
- Molded in high-strength non-corrosive Marelon
- Their great strength, light weight, and complete freedom from corrosion and electrolysis make them the ideal valve for controlling inlet and outlet water requirements above and below the waterline
- Teflon seals are standard on all valves
- N.P.S.F. straight thread



Part #	Thread	Height	Base
MPS 904009	1/2"	3"	3"
MPS 904010	3/4"	3"	3"
MPS 904011	1-1/2"	5"	6"

Marelon Thru Hull Kits

- Full-flow seacock with mushroom thru hull
- Includes both a 90 and straight hose barb
- ABYC H-27 Compliant



Part #	Hose ID	Thru Hull OD
MPS 904042ABYC	1/2"	1-1/8"
MPS 904043ABYC	3/4"	1-1/8"
MPS 904044ABYC	1"	1-1/2"
MPS 904045ABYC	1-1/4"	1-1/2"
MPS 904046ABYC	1-1/2"	2-1/8"
MPS 904048ABYC	2"	2-1/8"

Marelon Ball Valves

- Component style ball valves
- Molded in high-strength non-corrosive Marelon
- Their great strength, light weight, and complete freedom from corrosion and electrolysis make them the ideal valve for controlling inlet and outlet water requirements above and below the waterline
- Teflon seals are standard on all valves
- N.P.S.F. straight thread



Part #	Thread	Diameter	Length
MPS 905100	1/2"	1-7/8"	3"
MPS 905101	3/4"	1-7/8"	3"
MPS 905102	1"	2-3/4"	4-3/4"
MPS 905103	1-1/4"	2-3/4"	4-7/8"
MPS 905104	1-1/2"	3-1/2"	5"
MPS 905105	2"	4-1/4"	5-7/8"

Marelon Right Angle Thru Hull Valves

- Full-flow seacock with mushroom head threaded thru-hull and 90° hose barb
- ABYC H-27 Compliant



Part #	Hose ID	Note	Thru-Hull OD
MPS 931153	3/4"	-	1-1/8"
MPS 931156/930137	1-1/2"	w/locking handle	2-1/8"

Sealand**1-1/2" PVC Ball Valve**

- Ideal for use as an inline valve in a sanitation system
- Includes 1 x SLD 602 valve and 2 x SLD 341513 adapters

Requires gluing*

SLD 346087	Complete
SLD S-602	Valve only
SLD 341513	Hose adapters

**Groco Bronze Flange Adapters**

- Eliminates common (and dangerous) thread mismatch when in-line valves are screwed onto thru hulls
- Accepts standard thru-hulls into the base and standard in-line valves or other components on top
- Provides a safe and sturdy assembly when in-line valves are used as seacocks
- Prevents valve damage during engine or generator installation - the valve can be installed later
- Make future valve replacement a simple job
- Bonding attachment
- BSPP to NPT

GRO IBVF-750	3/4" NPT
GRO IBVF-1000	1" NPT
GRO IBVF-1250	1-1/4" NPT
GRO IBVF-1500	1-1/2" NPT
GRO IBVF-2000	2" NPT

**Buck Algonquin Seacocks**

- Low profile drain & grounding screw, full flow bronze body, hard chromed bronze ball, stainless steel handle
- UL labelled
- Rated 600 PSI

BUC ASC75LP	3/4" NPT
BUC ASC100LP	1" NPT
BUC ASC125LP	1-1/4" NPT
BUC ASC150LP	1-1/2" NPT
BUC ASC200LP	2" NPT
BUC ASC250LP	2-1/2" NPT

**Groco Safety Seacock Conversion**

Converts any seacock to a safety seacock. The quick-release plug feature allows the engines to act as high capacity bilge pumps in an emergency and simplifies routine maintenance and winterizing (using the supplied adapter). Simply screw into the top of any seacock. Allows normal seacock operation. All bronze castings.

GRO SSC-1500*	1-1/2" ID Hose x 1-1/2" NPT
* Request Item	

**Groco Bronze Ball Valves**

- Handle has square hole to accept standard ratchet to help access hard-to-reach valves and ease actuation of hard to operate valves
- 400 WOG rated
- Full pipe size flow
- Stainless steel handle and hardware.
- Chrome plated solid brass ball (not a hollow ball)
- Bonding attachment
- PTFE seats and seals
- Full flow
- UL Listed for fuel
- Fits IBVF for Seacock application

GRO IBV-500	1/2" NPT
GRO IBV-750	3/4" NPT
GRO IBV-1000	1" NPT
GRO IBV-1250	1-1/4" NPT
GRO IBV-1500	1-1/2" NPT
GRO IBV-2000	2" NPT

**Buck Algonquin Bronze Ball Valves**

- Bronze body, hard chromed bronze ball
- Stainless steel handle
- Full flow
- Rated 600 PSI
- Grounding screw



Part #	Size	Handle Kit †
BUC BBV-38LP	3/8"	BUC BBV-KIT38LP
BUC BBV-50LP	1/2"	BUC BBV-KIT50LP
BUC BBV-75LP	3/4"	BUC BBV-KIT75LP
BUC BBV-100LP	1"	BUC BBV-KIT100LP
BUC BBV-125LP	1-1/4"	BUC BBV-KIT125LP
BUC BBV-150LP	1-1/2"	BUC BBV-KIT150LP
BUC BBV-200LP	2"	BUC BBV-KIT200LP
BUC BBV-250LP	2-1/2"	-

† Includes handle and retaining nut

Buck Algonquin Bronze Ball Valve

- Bronze body, hard chromed bronze ball
- Stainless steel handle
- Full flow
- Rated 600 PSI

BUC BBV-25FSS	1/4"
----------------------	------

**Fairview Forged Brass Ball Valve**

- For natural and propane gas use
- C.S.A. certified to C.G.A
- Rated to 125 PSI
- 1/4" FNPT

FRV BV2103-B**Fairview Cast Brass Ball Valve**

- 3/8" FNPT

FRV BV4103-C

Brass Full Port Ball Valves

- Chrome plated solid brass ball
- Teflon seats
- Full ports for min. pressure drop
- 400 PSI cold water, oil or gas
- 150 PSI steam
- Quarter turn operation
- Vinyl insulator on flat cadmium plated steel handle
- Part # indicates pipe thread size

**VAL B-3 1/4"****VAL #220-T-3/8"****VAL B-3 1/2"****VAL B-3 3/4"****VAL B-3 1"****VAL B-3 1-1/4"****VAL #220-T-1-1/2"****VAL B-3 2-1/2"****VAL B-3 3"**

Replacement Handles:

VAL 1/2"-3/4"**VAL 1"B-3****VAL 1-1/4" B-3****VAL 1-1/2"-2"****Stainless Steel Full Port Ball Valves**

- Two piece body, full port stainless steel ball valves
- Adjustable packing nut
- Locking lever 304 stainless handle
- 1000 P.S.I. body and ball assembly is 316 stainless
- Part # indicates pipe thread size

**VAL BV 1/4"S/S****VAL BV 3/8"S/S****VAL BV 1/2"S/S****VAL BV 3/4"S/S****VAL BV 1"S/S****VAL BV 1-1/4"S/S****VAL BV 1-1/2"S/S****VAL BV 2"S/S**

Replacement Handles:

VAL 1T2LH 1"-1-1/4" (BV 1"S/S & 1-1/4"S/S)**VAL 2T2LH** 1-1/2"-2" (BV 1-1/2"S/S & 2"S/S)**VAL 14T2LH** 1/4"-1/2" (BV 1/4"S/S, 3/8"S/S & 1/2"S/S)**Brass Gate Valve**

- F.I.P. threaded ends
- Non-rising stem
- 200 PSI cold water, oil or gas
- Solid wedge disc
- Part # indicates pipe thread size

**VAL 150T 3"****Fairview****Brass Spring Bottom Shut-Off Cocks**

- Pipe - Female to Female

FRV 2103-A 1/8"**FRV 2103-B** 1/4"**FRV 2103-C** 3/8"

- Pipe - Female to Male

FRV 2120-B 1/4"**Fairview Brass Closed Bottom Shut-Off Cocks**

- Pipe - Female to Female

FRV 5103-B 1/4"**FRV 5103-C** 3/8"**Racor Brass Shut-Off Valve**

- Open/close valve
- 1/4" NPT fittings

**RAC RK 19492****Fairview Brass Angle Valves**

Part #	Hose ID	Male Pipe
FRV 1139-10C	5/8"	3/8"
FRV 1139-10D	5/8"	1/2"

**Fairview Brass Mini Ball Valve**

- Pipe - 1/4" Female to 1/4" Male

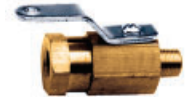
FRV BV3120-B**Bronze 3-Way Ball Valves**

- Large port, female internal pipe threads
- 400 PSI cold water, oil or gas
- 100 PSI at 300°F
- Part # indicates pipe thread size

**VAL KITZ 54 3/8"****VAL KITZ 54 1/2"****VAL KITZ 54 3/4"****VAL KITZ 54 1"****VAL KITZ 54 1-1/4"****VAL KITZ 54 1-1/2"****VAL KITZ 54 2"****Brass 3-Way Ball Valves**

- Forged 2 piece construction
- Reduced L-Port
- 2 seat design
- ANSI B1.20.1 NPT ends
- Blowout-proof stem
- Chrome plated ball
- Oring stem seals
- Panel mounting holes
- Class 150, 400 WOG
- Part # indicates pipe thread size

**VAL MAS B-3L-3/8"****VAL MAS B-3L-1/2"****VAL MAS B-3L-3/4"****VAL MAS B-3L-1"****VAL MAS B-3L-1-1/4"****VAL MAS B-3L-1-1/2"****VAL MAS B-3L-2"****Fairview****Brass Saddle Tank Valves w/Click**

- Internal nylon plug provides long life, excellent seal and easy operation
- Click indicates fully open or closed
- Recommended for low pressure use in gasoline, oil, air, or water systems
- With mounting bracket
- All ports female pipe



Part #	Stem	FPT	
FRV 2101-B	1-3/8"	1/4"	3-Way
FRV 2101-C	1-3/8"	3/8"	3-Way
FRV 2102-C	1-3/8"	3/8"	4-Way

Moeller Brass Valves

- Click indicates fully open or closed
- With mounting bracket

MOE 033305-10 1/4" FNPT 3-way valve
MOE 033312-10 3/8" FNPT 3-way valve



Moeller Shut-Off Valve

- Constructed of brass
- Meets ABYC H-24 requirements
- Fits most shaft seal crossover fittings

MOE 033306-10 3/8" barb x 1/4" NPT



Fairview Brass Drain Cocks

- Back seating type

FRV 240-A 1/8"
FRV 240-B 1/4"
FRV 240-C 3/8"
FRV 240-D 1/2"



Fairview Brass Drain Cocks

- Needle seat one-piece plug and handle

FRV 242-A 1/8"
FRV 242-B 1/4"



Fairview Brass Shut-Off Needle Valves

- Flare - tube to tube. Up to 150 PSI

FRV 3042-6 3/8"



Jabsco 'Y' Waste Valve

- "Y" valve is designed for installation in waste discharge and bilge pump out systems
- Self cleaning, large, easy to turn handle locks if need be
- 1-1/2" curved discharge ports can be rotated 360° to accommodate many configurations
- Supplied with both 1-1/2" and 1" straight inlet port for easy attachment to toilets with 1" discharge hoses



JAB 45490-1000 "Y" valve

Parts:

JAB 45500-1000 Handle extension spacer kit

JAB 45488-0000 Gasket Kit

JAB 45493-0000 Replacement handle

Marelon 'Y' Valves

- High-strength non-corrosive Marelon
- Operated by a simple 120° movement
- Positive stops are provided between positions
- Base diameter: 3-1/2"

MPS 902000 1-1/2"

MPS 902001 1"

Parts:

MPS 902006 Repair kit (handle, valve gate & o-ring)



Bosworth Sea-lect 'Y' Valves

- Redesigned for ease of turning and to resist valve "freeze-up"
- Corrosion resistant
- Full port opening; interior parts do not restrict flow
- Valve handle turns right or left to close off desired intake
- Removable travel stops convert from 2 to 3 way operation



94AB-3/4-CPH

M94AB-3/4-CPH

94-CPH



BM-95-CPH

M-95-CPH

BOS 94AB-3/4-CPH 3/4" hose barb, base mount
BOS M94AB-3/4-CPH 3/4" hose barb, flush mount
BOS 94-CPH 1" smooth, base mount
BOS BM95-CPH 1-1/2" hose barb, base mount
BOS M95-CPH 1-1/2" hose barb, flush mount

Parts:

BOS #4-HANDLE Replacement handle for 94/95

BOS #4M-HANDLE Replacement handle for M-95 & M94AB

Bosworth Check Valves



74AB Series

75 Series

- Simple inexpensive in-line valves
- Used for keeping pumps primed, etc.

BOS 74F4 Female 1/2" NPT x Female 1/2" NPT
BOS 74AB 1/2" 1/2" hose barb x 1/2" hose barb
BOS 74AB 3/4" 3/4" hose barb x 3/4" hose barb
BOS 74-6 3/4" hose
BOS 74-8 1" hose
BOS 74-9 1-1/8" hose
BOS 75-12 1-1/2" hose

Sealand

1-1/2" PVC Check Valves

- Smooth barbs allow for easy installation and removal
- Heavy duty unit will allow replacing of the check valve without removing the hose

SLD 238696 Standard unit
SLD 300011 Heavy duty unit



Shurflo In-Line Check Valve

- Allow flow in one direction only
- Safeguard against back surge to 100 PSI

SHR 340-001

1/2" hose barb

**T-H Marine Check Valve**

- Prevents backwash
- Chemical resistant materials
- Thermo-plastic flapper
- 1-1/8"

**THM ILS-1200-DP****Whale Check Valves**

- Provide an easy way to maintain prime in a suction or discharge line
- Designed to fit in-line
- Suitable for use with manual or electric pumps
- Glass-filled Polypropylene, Valve: Nitrile

**WHA LV1218**

25mm (1"), 28mm (1-1/8")

WHA LV1219

19mm (3/4"), 25mm (1")

Fairview Coupling Style Check Valve

- 3/8" female pipe thread
- 200 PSI non-shock cold water, oil and gas
- Forged construction
- Can be installed horizontal or vertical
- Less than 1 PSI cracking pressure

**FRV 103CV-C****Groco****CV Series Check Valves**

CV Series in-line check valve may be used in water systems or fuel systems to keep pumps primed and to prevent back-flow. The unique design reduces flow turbulence and restriction, thus improving pump performance.

- C83600 cast bronze construction
- NPT threaded ports
- Suitable for use with diesel fuel or gasoline



Part #	NPT	Dia	Length	PSI to open
GRO CV-50	1/2"	1.42"	2.45"	0.33
GRO CV-75	3/4"	1.65"	2.58"	0.16
GRO CV-100	1"	1.9"	3.3"	0.19
GRO CV-125*	1-1/4"	2.38"	3.98"	0.1
GRO CV-150	1-1/2"	2.93"	4.34"	0.1

* Request Item

Shurflo Pressure Regulator

- Hooks directly to 3/4" garden hose or city water faucet
- Reduces pressure to 50 psi
- Includes 3/4" garden hose to 1/2" pipe adapter
- 3-1/2" x 2"

**SHR 183-039-08****Jabsco Water Pressure Regulators**

- Limits inlet water pressure to 45 PSI (3.1 bar)
- Maintains regulated pressure at various flow rates
- Swivel elbow output
- Manufactured of food-grade materials
- Removable strainer protects plumbing
- 1/2"-14 pipe connection
- Inlet: 3/4" FGHT
- D: 3-1/2" x H: 4-3/8" x W: 4-7/8"

JAB 44411-1045

White

JAB 44411-2045

Chrome

**Gemlux Water Inlet**

- 316 cast stainless steel
- Stainless steel ball chain and black plastic cap
- 2-3/4" OD
- For use with 3/4" hose

GEM 330190**Perko Fresh Water Inlet**

- Chrome plated bronze
- For water under pressure at dockside
- External portion has a swivel hose connector with watertight plug and stainless bead chain
- Pipe size: 1/2"
- Flange: 2-3/4 OD

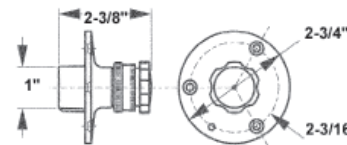
PER 499-DP-CHR**Sea-Dog Fresh Water Inlets**

- Comes with standard female swivel hose connector
- Pipe size 1/2" FIPT x 3/4" FGHT
- Use #8 F.H. fasteners

SED 512110-1

Brass chrome plated

SED 513110-1

Cast 316 stainless steel

**Perko Water Outlet**

- Chrome plated bronze
- Standard male hose connector for use with on-board washdown systems
- Watertight black plastic cap and stainless steel bead chain
- Pipe size: 1/2" IPT x flange: 2-3/4"OD

PER 504-DP-CHR

Parts:

PER 504-DP-99A

Spare plug & chain

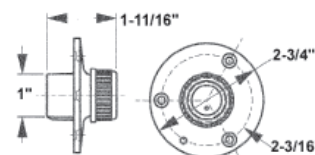
**Sea-Dog Fresh Water Outlets**

- Pipe size 1/2" FIPT x 3/4" MGHT
- Use #8 F.H. fasteners

SED 512120-1

Brass chrome plated

SED 513120-1

Cast 316 stainless steel



T-H Marine Water Outlet

- Injection molded nylon bulkhead mounted wash down fitting
- 2-1/4" diameter and mounts in a 1-1/4" diameter hole with 3 countersunk screws
- Barbed hose fitting connects 3/4" inside diameter tubing
- Standard hose threads with a protective cap which has a retaining strap is standard
- Comes with a shut-off valve in the spigot

**THM WDV-1-DP****Jabsco Washdown Outlet Kit**

- Flush mount 316 stainless steel 1/2" NPT female deckplate inlet fitting
- Comes with a 3/4" GHT hose adapter with a pre-installed check valve
- Quick, simple, twist connection
- 2-7/8" diameter top
- 1-3/8" hole cutout required

**JAB 31911-0000**

Parts:

JAB 31911-0002 Hose adapter only
JAB 31911-0003 Service kit (for inlet)

Scandvik Washdown Spigot

- 316 stainless steel spigot
- 1/4 turn ceramic valve
- Standard 3/4" garden hose thread for hose attachment
- Includes interchangeable FRESH and RAW pendant
- Mounts easily with 3 x #6 screws to bulkhead
- Water connection: 1/2" NPT-F
- H: 3-3/4" x D: 3-3/4" x Flange: 2-3/8"

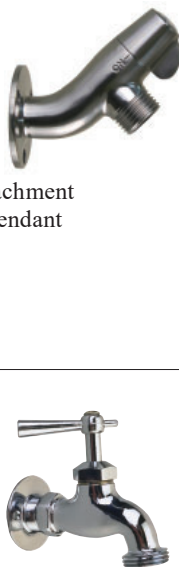
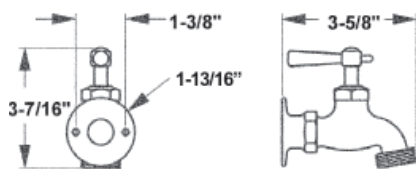
**SCA 10175****Sea-Dog Washdown Faucet**

- Chrome plated brass
- Ideal for exterior fresh water washdown
- Allows for control of the water flow on the exterior surface

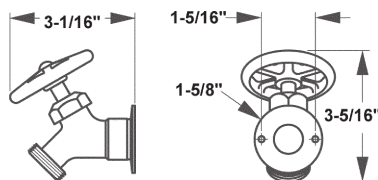
SED 512210-1 1/2" FIPT x 3/4" MGHT**Sea-Dog Washdown Faucet**

- Chrome plated brass
- Ideal for exterior fresh water washdown
- Allows for control of the water flow on the exterior surface

SED 512220-1 1/2" NPS-M x 3/4" NHM hose**Ambassador Washdown Spigot**

- Trinidad series
- Stainless steel, compression valve

AMB 133-0216-SS

► Also See

Faucets pg 823-824

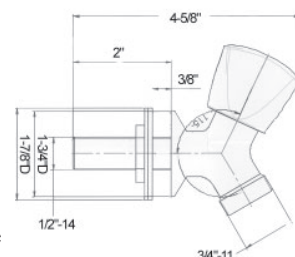
**Bosworth Vented Loops**

- Corrosion resistant plastic construction

BOS 30-1-1/8" 1-1/8" vented loop**BOS 30-1-1/2"** 1-1/2" vented loop

Parts:

BOS 31 Vacuum breaker**Buck Algonquin Bronze Vented Loops**

- Used in discharge and intake lines when toilet is installed below the waterline
- Automatic air vent prevents back siphoning



Part #	Hose Size	Height	Width
BUC VL-75	3/4"	2-1/2"	2-1/4"
BUC VL-150	1-1/2"	6-1/4"	7"

Parts:

BUC 60VL75CV Vent only VL-75**BUC 60VL150J** Vent only VL-150**Marelon Vented Loops**

- Precision molded in high-strength non-corrosive Marelon
- The one-way valve is designed to seal properly if particulate matter is present in fluids

MPS 903008 1/2"
MPS 903003 5/8"
MPS 903001 3/4"
MPS 903007 1"
MPS 903000 1-1/2"

Parts:

MPS 903002 Vent cap**MPS 903004** Vent barb

The MF-846 vent barb assembly option can be used in lieu of the standard MF-841 cap/duckbill. This option allows venting to the outside of the hull via a 1/4" hose.

**Groco Vented Loops**

- All bronze construction
- Includes mounting hardware
- The oversized vent valve is virtually clog free and can easily be removed without tools for inspection or cleaning
- Cap is threaded 1/2" NPT to allow overboard venting

GRO HVL-750 3/4" hose barb**GRO HVL-1000** 1" hose barb**GRO HVL-1500** 1-1/2" hose barb

Parts:

GRO VL-1504 Vacuum breaker assembly